



MONA JUNIOR BASIC SCHOOL

10TH 3/4 MILE TOPKHANA

KALIMPONG - 734316

ESTD 1973

PH. NO.

Ref.

Date. 23.12.2026...

Handwritten signature in green ink: Smt. Suman Prasad

सेवासा,
नगरपालिका अध्यक्ष
कालेमांड

बिषय - विद्यालयको पाईखाना (Toilet) अनि सेचो टंकीको नव
निर्माणको आवेदन पत्र
अर्थात्

तोपखाना कालेमांड अतिरिक्त नौना प्राथमिक
पाठशालाका शिक्षणार्थ हाजी शिक्षिकावशा वाट आज एजुर समक्ष यो
निवेदन पत्र चढाइरहेको कि एजुरले यस बिषय प्रति शीघ्र नै पहल
गरिदिनु हुने गर्नु पर्ने आशा गरिएको।

विषय - हाजी विद्यालयको पाईखाना धेरै पुरानो भएको छ साथै उक्त
पाईखानाको टंकी रूकदुमे सार्ने गर्नुको कारणले हाजी माथीहरूको
Toilet बन्द गरिएको छ र Toilet वाट मैला पानी बाहिर निकल्ने
कारणले दुबन्ध फैलिरहेको छ, सो दुबन्धले क्षेत्र परिपटि विचार
फैलिने सम्भावना रहनेले जसको निम्ति उक्त पाईखाना र टंकीको
व्यवस्थापना गर्न जरुरी छ।

त्यसैगरी उक्त कार्य, एजुरले आफ्नो पहलमा निरन्तर
गरिई यथाशीघ्र यसको व्यवस्थापन गरिई दिनु भए हाजी सम्पूर्ण
शिक्षिकावशा एजुर प्रति आभारी रहनेछौं।

धन्यवाद ।

842682804

तपाईंको विश्वास

Handwritten signature in blue ink: Priyanka

Headmistress
Mona Junior Basic School
10th Mile, Topkhana
Kalimpung-ESTD 1973

मोना प्राथमिक पाठशाला

१०^३/_४ माईल, तोपखाना,
कालिम्पोङ

223

संख्या 2779

दिनांक 14.9.79

ing.

To,
The Sub-Divisional Officer,
Kaliampeng.

Sub-Demarcation of D.I.F. Plot 400/part.

Sir,
I beg to state that there is a vacate D.I.F. Plot
No 400/part in the name of "Mona Primary School" Topkhana
1 1/4 mile, Kaliampeng Ward No A,

As we want to construct School Building there,
we want to fix the boundaries of said land,

I, therefore, request your honour to kindly depute
Tahsildar to demarcate the land for which will pay necessary
fees.

Thanking you,

Yours faithfully,

Hamid Quraisy,

Proposed SITE PLAN FOR SETTLEMENT
 OR LAND OUT OF PLOT NO. 490, AT 1^{1/2} MILE,
 TORRIANA, KALIMPANG, BY - PRESIDENT,
 MONA PRIMARY SCHOOL.

PROPOSED AREA SHOWN IN 

35'-0" x 50'-0" = 750 sq. ft.

35'-0" x 18'-0" = 630 sq. ft.

Total: 35'-0" x 68'-0" = 2380 sq. ft.

Scale 6" = 1 MILE

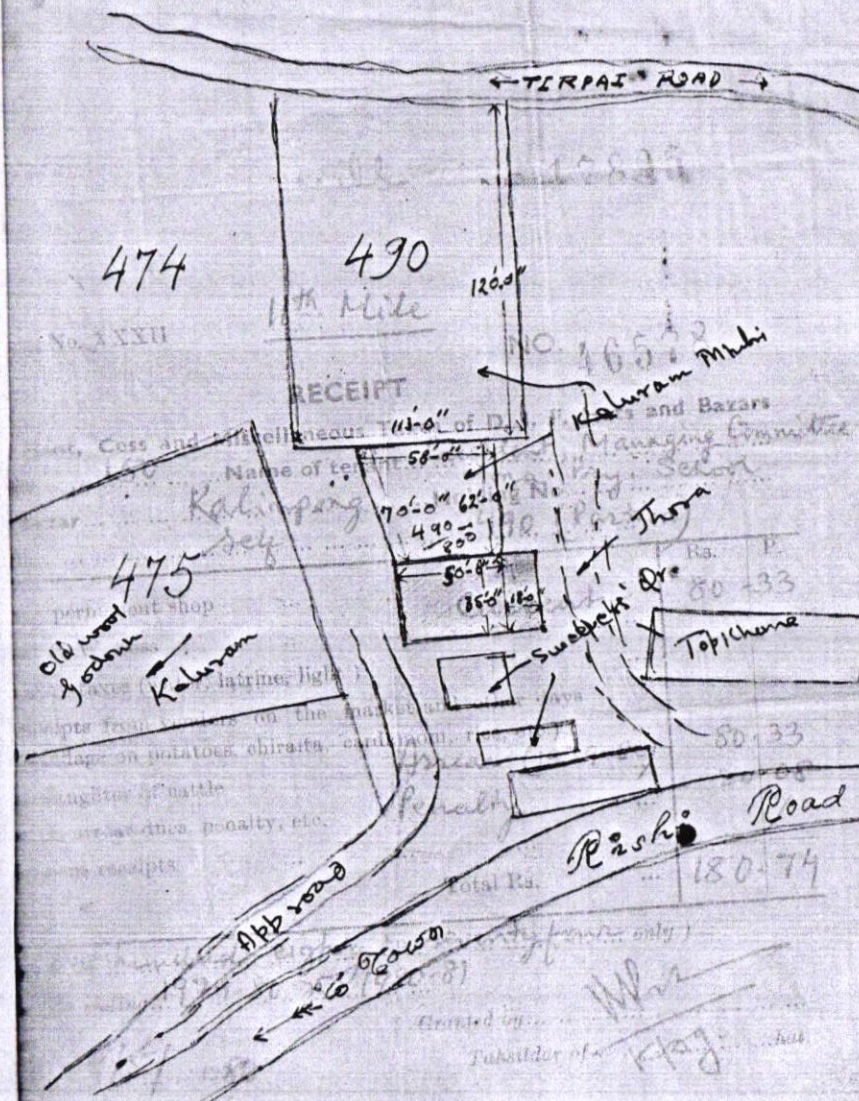

474

490

475

← TERPAI ROAD →

Rishi Road

App road

RECEIPT

Kaluram Mudi and Bazars

Managing Committee

Subject's Office

Topik Home

Old wood godown

Kaluram

Kalimpang

Wm

KAG

Total Ra. 180.74

Created in

Subsidiary of

Subsidiary of

FOR SETTLEMENT
 OF LAND UNDER PLOT NO H90 AT 11th MILE,
 OUT OF
 TOKHANA, KAILMPONG. BY PRESIDENT, MONA
 PRIMARY SCHOOL.
 PROPOSED AREA SHOWN IN YELLOW

$35'-0" \times 50'-0" = 1750 \text{ Sq. ft.}$
 $35'-0" \times 18'-0" = 630 \text{ Sq. ft.}$

Total $35'-0" \times 68'-0" = 2380 \text{ Sq. ft.}$

SCALE 6" = 1 MILE

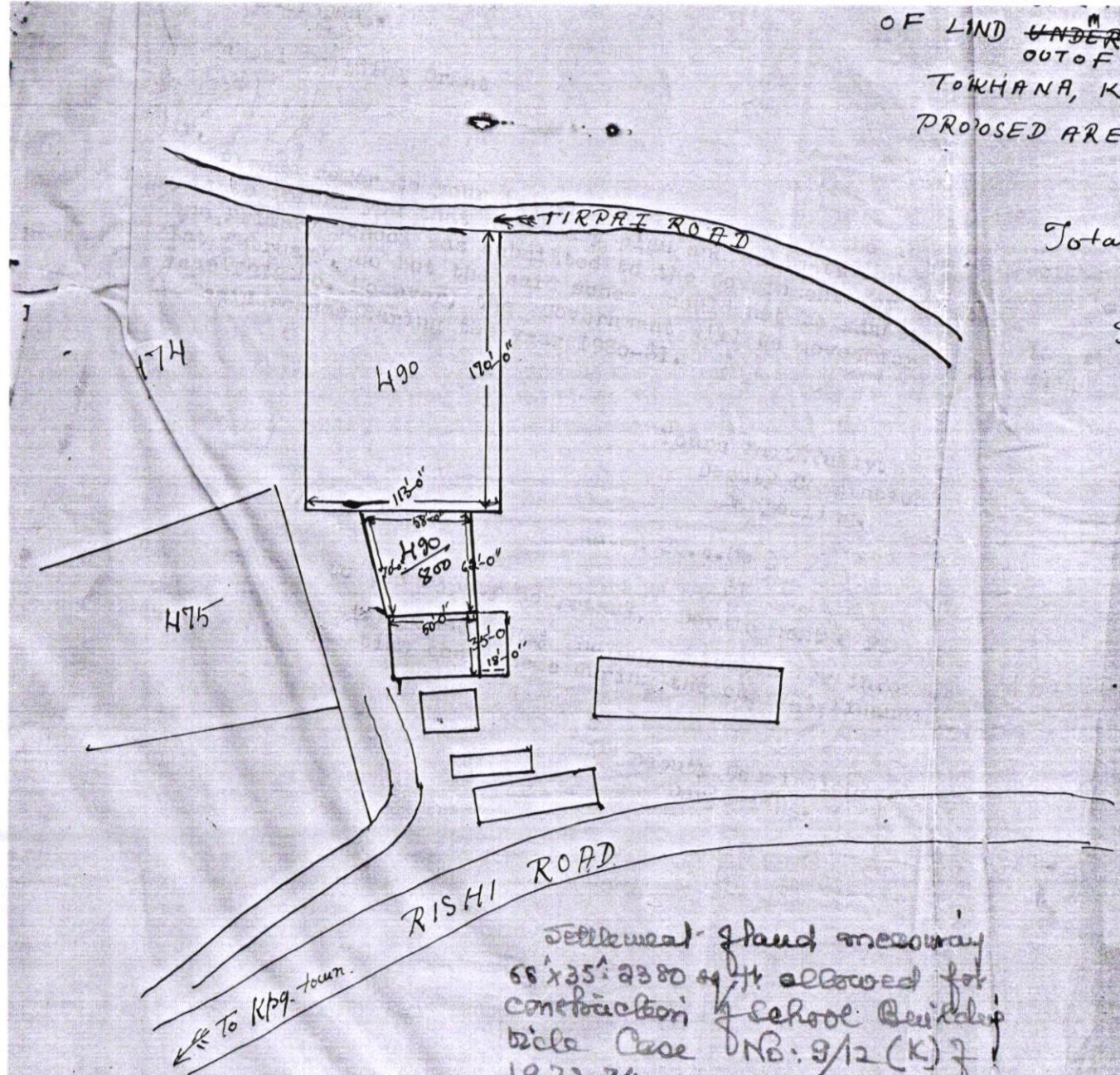

Settlement stand measuring
 55' x 35' = 2380 sq. ft. allowed for
 construction of school building
 vide Case DNB. 9/12 (K) of
 1973-74.

Sub-Divisional Officer,
 KAILMPONG

9/26
 A.T. 7/2/76

21/3/76.
 President
 Mona Primary School
 Tokhanna
 Kailmpong.