

RE: CONSTRUCTION OF WOMEN'S TOILET COMPLEX CUM BABY CARE ROOMS UNDER "KOLKATAR DOSH DIGANTA" SCHEME AT 25/3, OPPOSITE OF ASHUBABU BAZAR, PAIKPARA IN WARD NO-03 UNDER BOROUGH-I

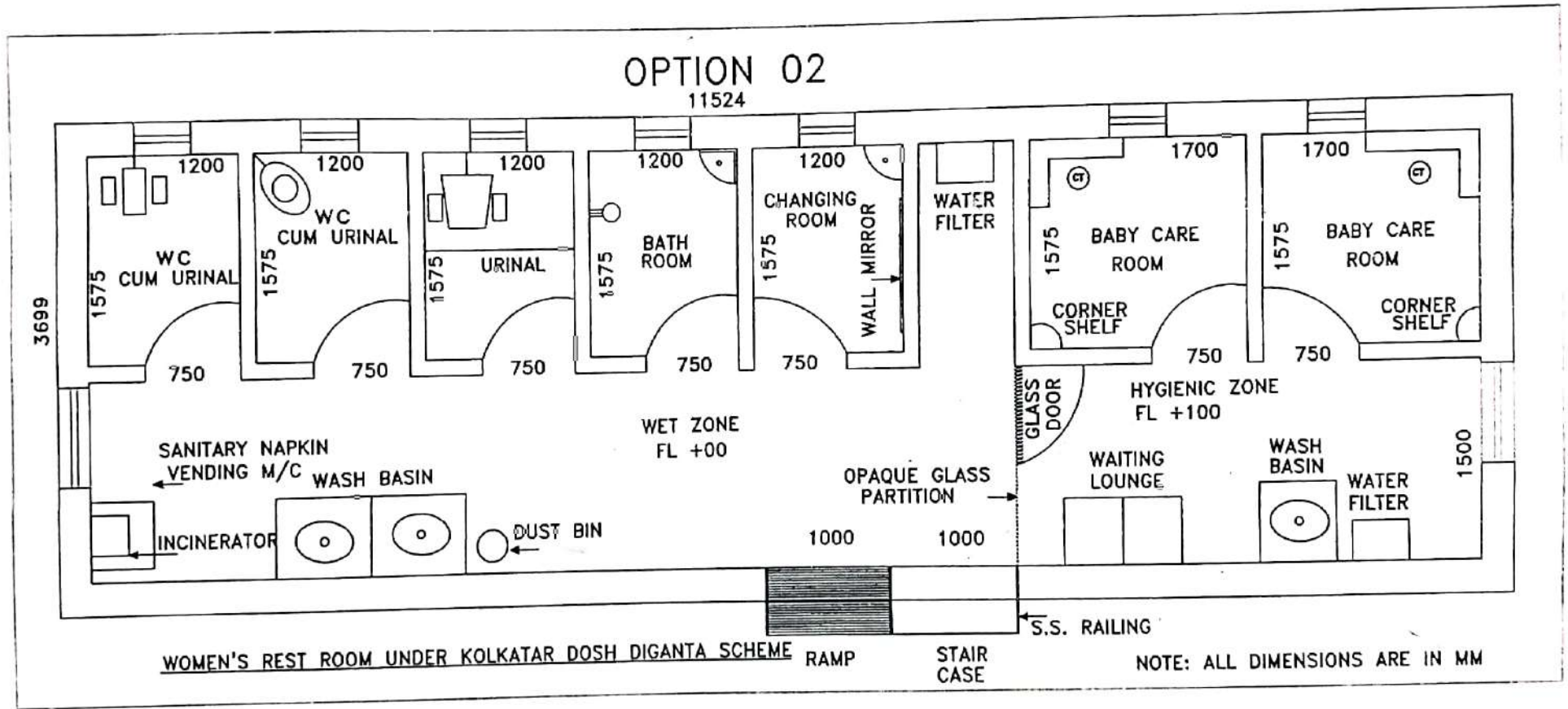

Samajit
17/2/26

AEC
17/2/26

AP
17.02.26

Executive Engineer (Civil)
Uttaran Services Department
K. M. C.

Sanjiv
17/02/26
Dy. Chief Engineer (Civil)
Uttaran Services Department
K. M. C.

D. G.
17/2/26
D. G.
Uttaran Services Department
K. M. C.

NAME OF WORK:- CONSTRUCTION OF WOMEN'S TOILET COMPLEX CUM BABY CARE ROOMS UNDER 'KOLKATAR 10 DIGANTA' SCHEME AT 25/3, OPPOSITE OF ASHUBABU BAZAR, PAIKPARA IN WARD NO 03 UNDER BOROUGH I

CIVIL WORK

Sl. No	Chk Lst	Sch. Item	Description of item	No	L	B	Ht.	Quantity	Unit	Rate	Amount Rs.
1	A1	P.W.D. (Bldg) 2017 Page 1, Item No. 1	Earthwork in excavation of foundation trenches or drains in all sorts of soil (including mixed soil but excluding latente or sand stone) including removing, spreading or stacking the spoils within a lead of 75m as directed. The item includes necessary trimming the sides of trenches levelling dressing and ramming the bottom bailing out water as required complete. Depth of excavation not exceeding 1500 mm								
	-		Footing	10	1.20	1.20	1.20	17.28			
			Below Tie Beam	2	11.524	0.375	0.45	3.89			
				5	3.699	0.375	0.45	3.12			
			Boundary	1	12.00	0.375	0.45	2.03			
	-		Under Ground Reservoir	1	2.50	1.50	1.20	4.50			
	A1		Total					30.82	% Cum	11927.00	3675.90
2	A1	P.W.D. (Bldg) 2017 Page 1, Item No. 3(a)	Earthwork in filling in foundation trenches or plinth with good earth in layers not exceeding 150mm. Including watering andramming etc. layer by layer complete (Payment to be made on the basis of measurement of finished quantity of work). With earth obtained from excavation of foundation								
	A1		1/5 th of Excavated Earth					6.16	%Cum	7754.00	477.65
3	A1	P.W.D. (Bldg) 2017, 5th Corr. 16.04.2019 Page 2, Item 1	Filling in foundation or plinth by silver sand in layers not exceeding 150 mm. As directed and consolidating same by thorough saturation with water ramming complete including the cost of supply of sand. (Payment to be made on measurement of finished quantity)								
				10	1.20	1.20	0.100	1.44			
				2	11.52	0.375	0.100	0.86			
				5	3.699	0.375	0.100	0.69			
				1	12.00	0.375	0.100	0.45			
				1	2.50	1.50	0.100	0.38			
				1	11.000	3.200	0.200	7.04			
				1	15.00	0.582	0.100	0.87			
	A1							11.73	%Cum	131714.00	15450.05
4	E7	P.W.D. (Bldg) 2017 3rd corr 04.06.2018, p-1	Single brick flat soling of picked jhama bricks including ramming and dressing bed to proper level and filling joints with powdered earth or local sand.								
				10	1.20	1.20		14.40			
				2	11.52	0.375		8.64			

amajm
Saw 17/2/26

af
NE(C)
17/2/26

AB
17-02-26

Sl. No	Chk Lst	Sch. Item	Description of item	No	L	B	Ht.	Quantity	Unit	Rate	Amount Rs.
				5	3.70	0.375		6.94			
				1	12.00	0.375		4.50			
				1	6.00	2.000		12.00			
				1	2.50	1.50		3.75			
				1	11.00	3.200		35.20			
				1	15.00	0.582		8.73			
	E7							94.16	Sqm	361.00	33991.76
	-										
5	M7	P.W.D. (Bidg) 2017, 3rd corr 04.06.2018, p-10	Cement concrete with graded jharma khoa (30 mm. size) excluding shuttering in ground floor and foundation. a) 1:3:6 Proportion								
	-		outside	10	1.20	1.20	0.075	1.08			
				2	11.52	0.375	0.075	0.65			
				5	3.70	0.375	0.075	0.52			
				1	12.00	0.375	0.075	0.34			
				1	6.00	2.000	0.075	0.90			
				1	2.50	1.50	0.075	0.28			
				1	11.00	3.20	0.075	2.64			
	M7							6.41	Cum	4761.00	30518.01
6	M7	P.W.D. (Bidg) 2017, 3rd corr 04.06.2018, p-10	Cement concrete with graded jharma khoa (30 mm. size) excluding shuttering in ground floor and foundation. a) 1:4:8 Proportion								
				3	0.60	0.40	0.30	0.22			
				1	15.00	0.157		2.36			
	M7							2.58	Cum	4566.00	11780.28
7	M7	P.W.D. (Bidg) 2017 Page 42, Item No. 36(a)	Hire and Labour charges for shuttering with centering and necessary staging upto 4m using approved stout, props and thick hard wood planks of approved thickness with required bracing for concrete slabs, beams, columns lintels, curved or straight including fitting, fixing and striking out after completion of works (upto roof of ground floor). 25 mm to 30 mm thick wooden shuttering as per decision & direction of Engineer-in-charge.								
			Footing	10	4.80	0.175		8.40			
			Column	10	1.00	5.40		54.00			
			Floor Beam	2	11.50	0.50		11.50			
				5	3.70	0.50		9.25			
			Roof Beam	2	11.50	0.50		11.50			
				5	3.70	0.50		9.25			

amajunt
SWS 11/21/26

UP
AEC
11/21/26

Sl. No	Chk Lst	Sch. Item	Description of item	No	L	B	Ht.	Quantity	Unit	Rate	Amount Rs.
			Slab	1	11.00	3.20		35.20			
				1	30.40	0.115		3.50			
			Lintel	2	2.00	0.250		1.00			
				2	2.00	0.300		1.20			
			Chajja	1	2.00	0.450		0.90			
				1	2.90	0.150		0.44			
				3	1.00	0.450		1.35			
				3	1.90	0.150		0.86			
			For Reservoir	1	2.00	1.000		2.00			
				2	2.00	1.800		7.20			
				2	1.00	1.800		3.60			
	M7							161.15	Sqm	335.00	53985.25
8	E7	KMC CONSOLIDATE RATE CIVIL_2018 2.26	Ordinary cement concrete (mix 1:1.5:3) with graded stone chips (20 mm. nominal size) excluding shuttering and reinforcement, if any, in ground floor as per IS codes. a) Pakur / Chandil Variety								
			Footing	10	1.20	1.20	0.175	2.52			
			Pedestal	10	0.845		0.35	2.96			
			Column	10	0.25	0.25	5.40	3.38			
			Floor & Roof Beam	4	0.25	0.25	11.50	2.88			
				10	0.25	0.25	3.70	2.31			
			Slab	1	11.52	3.699	0.115	4.90			
			Lintel	2	2.00	0.25	0.15	0.15			
			Chajja	1	2.00	0.45	0.15	0.14			
				3	1.00	0.45	0.15	0.20			
			Reservoir	1	2.50	1.50	0.115	0.43			
				2	2.00	1.80	0.075	0.54			
				2	1.00	1.80	0.075	0.27			
				2	3.00	0.450	0.15	0.41			
	E7		Total					21.09	Cum	6047.00	127531.23
9	E7	PWD S O R- 2017, 2ND Corr i- 1, dt 18.04.2018, p-2	Reinforcement for reinforced concrete work in all sorts of structures including distribution bars, stirrups, binders etc initial straightening and removal of loose rust (if necessary), cutting to requisite length, hooking and bending to correct shape, placing in proper position and binding with 16 gauge black annealed wire at every intersection, complete as per drawing and direction. (a) For works in foundation and upto roof of ground floor/upto 4 m (i) Tor steel/Mild Steel III. JSW, JSPL... SSL,, For 1st floor								
	E7		1.1% OF CEMENT CONCRETE Total					1.820	MT	68200.00	124124.00
10	E7	P.W.D (Bldg)	Brick work with 1st class bricks in cement mortar (4:1) a) In foundation and plinth								

amam
Saw 10/2/26

17/2/26

Sl. No	Chk Lst	Sch. Item	Description of Item	No	L	B	Ht.	Quantity	Unit	Rate	Amount Rs.
	-	2017 3rd corr. 04.06.2018, p-1,1-3		2	11.524	0.375	0.15	1.30			
				2	11.524	0.250	0.45	2.59			
				5	3.70	0.375	0.15	1.04			
				5	3.70	0.250	0.45	2.08			
				2	2.50	0.250	1.20	1.50			
				2	1.50	0.250	1.20	0.90			
			Step	2	1.50	0.250	0.45	0.34			
			Boundary	1	12.00	0.375	0.15	0.68			
	E7			1	12.00	0.250	0.45	1.35			
			Total					11.78	cum	5682.00	66933.96
11		P.W.D (Bldg) 2017 3rd corr. 04.06.2018, p-1,1-3	Brick work with 1st class bricks in cement mortar (4:1) b) In Superstructure & ground floor.								
				2	11.524	0.25	3.00	17.29			
				2	3.699	0.25	3.00	5.55			
				4	2.000	0.25	1.20	2.40			
								25.24	Cum	5905.00	149042.20
12	E7	P.W.D (Bldg) 2017 3rd corr. 04.06.2018, p-3,1-8	125 mm. thick brick work with 1st class bricks in cement mortar (1:4) in ground floor.								
				1	11.52	0.60		6.91			
				1	3.699	0.60		2.22			
	E7			1	3.00	2.10		6.30			
			Total					15.43	sqm	736.00	11359.28
13	A1	P.W.D (Bldg) 2017 3rd corr. 04.06.2018, p-18,1-46	Cement concrete (1:1.5:3) with graded stone chips 5.6mm. Size with hexagonal square mesh wire netting I.R.C. Fabric mesh or X.P.M. fitted and fixed after tying the existing reinforcement on concrete without distributing the same and with proper scraping and cleaning the reinforcement and disturbed concrete with wire brush etc. after applying a coat of cement excluding the cost of wire netting I.R.C. or X.P.M. but including cost of all handling and scaffolding complete as per direction of Engineer-in-charge. (a) 37.5mm thick.								
				1	11.524	3.699		42.63	sqm	593.00	25277.97
14		P.W.D (Bldg) 2017 3rd corr. 04.06.2018, p-18,1-46	25mm. Thick damp proof course with cement concrete with stone chips (1:1.5:3) [with graded stone aggregate 10 mm nominal size] and admixture of water proofing compound as per manufacture's specification followed by two coat of polymer based paint, (1st coat after 4 to 5 days of concrete laying and 2nd coat just before brick masonry work) as directed (cost of water proofing compound & polymer based paint to be paid separately). (Chequering not required over concrete or painted surface)								

amam
Saw 11/2/20

AFG
17/2/20

Sl. No	Chk Lst	Sch. Item	Description of Item	No	L	B	Ht.	Quantity	Unit	Rate	Amount Rs.
				2	11.524	0.25		5.76			
				2	3.699	0.25		1.85			
								7.61	sqm	190.00	1446.19
15		P.W.D. (Bldg) 2017 Page 47, Item No. 3	Supplying and laying polythene sheet (150gm/sqm.) over damp proof course or below flooring or roof terracing or in foundation trenches.								
				Same as Item No 7				161.15	Sqm	24.00	3867.60
16	A1	P.W.D. (Bldg) 2017, 3rd corr. 04.06.2018, p-50, I-1	Plaster (to wall, floor, ceiling etc.) with sand and cement mortar including rounding off or chamfering corners as directed and raking out joints including throating, nosing and drip course, scaffolding/staging where necessary (Groundfloor). (i) With 1:6 cement mortar (b) 20 mm thick plaster(external) ground floor								
	-			1	30.40	4.20		127.68			
	A1		Total					127.68	Sqm	175.00	22344.00
17	A1	P.W.D. (Bldg) 2017, 3rd corr. 04.06.2018, p-50, I-1	(i) With 1:6 cement mortar C) 15 mm thick plaster (internal)								
	-			1	28.40	0.80		22.72			
	A1		Total					22.72	Sqm	151.00	3430.72
18	-	P.W.D. (Bldg) 2017, 3rd corr. 04.06.2018, p-50, I-1(ii)c	(ii) With 1:4 cement mortar (c) 10 mm thick plaster								
	-			1	11.00	3.200		35.20			
	A1							35.20	Sqm	133.00	4681.60
19	E1	P.W.D. (Bldg) 2017, 3rd corr. 04.06.2018, p-36, I-22	Supplying, fitting & fixing 1st quality Ceramic tiles in walls and floors to match with the existing work & 4 nos. of key stones (10mm) fixed with araldite at the back of each tile & finishing the joints with white cement mixed with colouring oxide if required to match the colour of tiles including roughening of concrete surface, if necessary or by synthetic adhesive & grout materials etc. (B) Wall With Sand Cement Mortar (1:3) 15 mm thick & 2 mm thick cement slurry at back side of tiles using cement @ 2.91 Kg/Sq.m & joint filling using white cement slurry @ 0.20kg/Sq.m. (a) Area of each tile Above 0.09 Sq.m (i) Coloured decorative								

amgum
Saw 12/1/26

12/2/26

No	Chk Lst	Sch. Item	Description of item	No	L	B	Ht.	Quantity	Unit	Rate	Amount Rs.
-	-	-	Toilet wall	1	28.40	2.70		76.68			
-	-	-		3	2.00	3.50		21.00			
-	E1	-	Total					97.68	Sqm	1109.00	108327.12
20	E7	P.W.D. (Bldg) 2017, 3rd corr. 04.06.2018, p-37, I-26	Supplying & laying 20 mm designer chequered tiles of any shade and of approved quality as per IS: 1237: 1980 laid in patterns as directed in pavement, footpath including necessary underlay 25 mm thick average cement mortar (1:3) complete in all respect with all labour and materials [using cement slurry @ 4.4 kg/Sq m at back side of tiles. Cement of mortar & slurry will be supplied by the Department. Border concrete if necessary to be paid separately].								
-	-	-	Front area	1	11.524	2.00		23.05			
-	E7	-	Total					23.05	Sqm	836.00	19268.13
21	M4	P.W.D. (Bldg) 2017 Page 104, Item No. 13	(a) M.S. or W.I. Ornamental grill of approved design joints continuously welded with M.S., W.I. Flats and bars of windows, railing etc. fitted and fixed with necessary screws and lugs in ground floor. ii) Grill weighing above 16 Kg./sq.mtr and above								
-	-	-	Ventilator	2	1.20	1.20		2.88			
-	-	-		7	0.50	0.50		1.75			
-	-	-		1	2.00	1.20		2.40			
-	-	-						7.03	Sqm		
-	-	-						16 kg per sqm			
-	-	-						112.48	Kg		
-	M4	-	Total					1.12	Qntl	7238.00	8141.30
22	M6	P.W.D. (Bldg) 2017, 3rd corr. 04.06.2018, p-37, I-25	Collapsible gate with 40mm X40mm X6mm. Tee as top and bottom guide rail 20mm X10mm X2mm. Vertical channels 100mm. Apart in fully stretched position 20mm X5mm. M.S. flats as collapsible bracing properly rivetted and washered including 38mm. Steel rollers including locking arrangements, fitted and fixed in position with lugs set in cement concrete and including cutting necessary holes, chasing etc. in walls, floors etc. and making good damages complete in ground floor.								
-	M6	-	Main gate	1	2.00	2.10		4.20	Sqm	4330.00	18186.00

Sanjay Singh
17/2/26

AFCC
17/2/26

No	Chk Lst	Sch. Item	Description of item	No	L	B	Ht.	Quantity	Unit	Rate	Amount Rs.
23	M6	P W D (Bldg) 2017 Page 297, Item No 26(b)	Providing and fixing of factory made uPVC casement window (White Colour) (U value=1.9-1.3 W/m ² K, flame resistant, self extinguishing, lead free) comprising uPVC multi-chambered frame, Sash, & Mullion with having wall thickness of 2.3 mm (±0.2 mm) duly reinforced with G.I. section 1.6 mm (±0.2 mm) made from roll forming process of required length. All corners of frame and sash will be fusion welded. mullion (if required) shall be also fusion welded including drilling of holes for fixing hardware's, uPVC extruded glazing beads of appropriate dimension, EPDM gasket, G.I fasteners 100 x 8 mm size for fixing frame to finished wall, plastic packers, plastic caps and necessary stainless steel screws etc. shall be provided in all frame, sash & mullion, wherever necessary. Thereafter, 5 mm clear annealed glass shall be provided in the sash with the help of uPVC glazing bead and hardware, i.e., stainless steel (SS 304 grade) friction hinges & zinc alloy (white powder coated) casement handles (in window) & 3D Hinges & Multipoint Lock (in door) shall be provided. Window frame shall be fixed to the wall with 100mm long and 8mm dia. Fasteners and after fixing frame the gap between frame and adjacent finished wall shall be filled with weather proof silicon sealant over backer rod of required size, of approved quality complete in all respect as per approved drawing & direction of Engineer-inCharge (Note: Profile manufacturer & Window Manufacturer must be one & same, Only manufacturer Warranty is acceptable) b) Casement Door with glass / uPVC panel frame of size 67 x 62 mm & Sash of size 67 x 115 mm & Mullion (if required) of size 67 x 78 mm both having wall thickness of 2.3 ± 0.2 mm.								
	M6			1	2.00	2.10		4.20	Sqm	8657.00	36359.40
24	M6	P W D (Bldg) 2017 Page 291, Item No 18	Supplying, fitting & fixing Stainless Steel 'D' or 'H' type of size 300 mm x 19 mm tubular Handle with Grade 304, CE certified, marked & conforming to EN - 1154, of approved quality of reputed brand as per direction of Engineer-inCharge fitted and fixed complete including all incidental charges.								
	M6			2				2.00	Each	1571.00	3142.00
	-										
25	-	P W D (Bldg) 2017 Page- 195, Item- 7 (i)	Applying Interior grade Acrylic Primer of approved quality and brand on plastered or concrete surface old or new surface to receive Distemper/ Acrylic emulsion paint including scraping and preparing the surface thoroughly, complete as per manufacturer's specification and as per direction of the EIC. (In Ground Floor)(a) One Coat ii) Solvent based interior grade Acrylic Primer								
	-		For ceiling	1	28.40	0.80		22.72			
	-			1	11.00	3.20		35.20			
	-										
	E1							57.92	%Sqm	3370.00	1951.90
	-										
26	-	P W D (Bldg) 2017 Page- 196, Item- 10	Acrylic Distemper to interior wall, ceiling with a coat of solvent based interior grade acrylic primer (as per manufacturer's specification) including cleaning and smoothing of surface. Two Coats								

amgmm
SAC 17/2/26

AE (C)
17/2/26

No	Chk Lst	Sch. Item	Description of item	No	L	B	Ht.	Quantity	Unit	Rate	Amount Rs.
	E1			Same as Item No 25				57.92	Sqm	70.00	4054.40
	-										
	-										
27	E1	P.W.D (Bldg) 2017 Page-196 .Item- 8 (b)	Applying Exterior grade Acrylic primer of approved quality and brand on plastered or concrete surface old or new surface to receive decorative textured (matt finish) or smooth finish acrylic exterior emulsion paint including scraping and preparing the surface thoroughly, complete as per manufacturer's specification and as per direction of the EIC. In Ground Floor: (a) One Coats								
	-		For outside wall area	1	30.40	4.20		127.68			
	E1		Total					127.68	%Sqm	3140.00	4009.15
28	E1	P.W.D (Bldg) 2017 Page-197 .Item- 17	Protective and Decorative Acrylic exterior emulsion paint of approved quality, as per manufacturer's specification and as per direction of Engineer-in-Charge to be applied over acrylic primer as required. The rate includes cost of material, labour, scaffolding and all incidental charges but excluding the cost of primer. In Ground floor (Two Coat) a) Normal Acrylic Emulsion								
	-		For outside wall area	1	30.40	4.20		127.68			
	E1							127.68	Sqm	67.00	8554.56
	-										
29	M4	P.W.D (Bldg) 2017 Page-200/ Itm.1(a)	(a) Priming one coat on steel or other metal surface with synthetic oil bound primer of approved quality including smoothening surfaces by sand papering etc.								
	-		Ventilator	2	1.20	1.20		2.88			
	-		Collapsible gate	7	0.50	0.50		1.75			
	-		railing	1	2.00	2.10		4.20			
	-		railing	1	2.00	1.20		2.40			
	M4		Total					11.23	Sqm	29.00	325.67
	-										
30	M4	P.W.D (Bldg) 2017 Page-200/ Itm.2(a), (iv)	(A) Painting with best quality synthetic enamel paint of approved make and brand including smoothening surface by sand papering etc. including using of approved putty etc. on the surface, if necessary : (b) On steel or other metal surface : With super gloss (hi-gloss) - (iv) Two coats (with any shade except white)								
	M4		Same as item no 26					11.23	Sqm	79.00	887.17
	-										
31	M2	P.W.D (S&P) 2017 Page -41 It No -1(iii)	Wash basin vitreous china of approved make (without fittings) supplied, fitted and fixed in position on 75mmX75mmX75 mm wood blocks and C.I. brackets including two coats of painting of C.I. brackets. (iii) 630 mm X 450 mm size	3				3.00	Each	2435.00	7305.00

Signature
17/2/20

Signature
17/2/20

Sl. No	Chk Lst	Sch. Item	Description of item	No	L	B	Ht.	Quantity	Unit	Rate	Amount Rs.
32	M2	Page -43 It No 9(v) of P.W.D'S Sanitary Schedule	Supplying, fitting and fixing approved brand P.V.C. CONNECTOR white flexible, with both ends coupling with heavy brass C.P. nut, 15 mm dia. long.	6				6 00	Each	147.00	882.00
33	M1	P.W.D (S&P) 2017 Page -36 It No --2	Supplying, fitting and fixing 10 litre P.V.C. low-own cistern conforming to I.S. specification with P.V.C. fittings complete, C.I. brackets including two coats of painting to bracket etc.	3				3 00	Each	1015.00	3045.00
34	M7	P.W.D (Bldg) 2017, 7th corr 22.01.2020, p-1,1-1	Constructing Inspection pit of inside measurement 600mm X 600mm X upto 600mm (depth) with 250mm Thick 1st class brick work in cement mortar (1:4) on all sides, bottom of the pit consisting of 100mm Thick cement concrete (1:3:6) with stone chips over a layer of Jhama brick flat soling, 15mm. thick (1:4) cement plaster to inside walls and out-side walls upto G.L. and 20mm thick (1:4) plaster to bottom of the pit, providing necessary invert with cement concrete (1:3:6) with stone chips as per direction, neat cement finishing to entire internal surfaces, top of the pit covered with 100mm thick R.C.C. slab (1:1:5:3) with stone chips and necessary reinforcement upto 1% and shuttering including 6mm thick cement plaster (1:4) in all external surfaces of the slab and one 560mm dia R.C.C. manhole cover of approved make supplied, fitted and fixed in the slab with necessary fittings, necessary earth work in excavation in all sorts of soil, filling sides of the pit with earth and removing spoils after work complete in all respect with all costs of labour and materials. With Pakur variety.	6				6 00	Each	7253.00	43518.00
35	M7	Sanitary & Plumb 2017 Page-66, Item No. 16	Supplying fitting and fixing with cement jointing (3:1) salt glazed stoneware pipe including excavation of earth upto 1.50m depth in all sorts of soil both mixed or unmixed and refilling (but excluding concreting at bottom and sides).								
	M7		iii) 150 mm Dia	1	15.00			15 00	Metre	334.00	5010.00
36	E2	P.W.D (S&P) 2017 P. 81, It 15(ii)(E2)	Supplying, fitting and fixing beveled edged mirror 5.5 mm thick silver red as per I.S. 3438 / 1965 together with brass C.P. hinges. (ii) 600 mm X 450 mm	5				5 00	Each	484.00	2420.00
37	E5	Page -45 It. No. 19(a)(ii) of P.W.D'S Sanitary Schedule	Supplying, fitting and fixing pillar cock of approved make. a)(ii) C.P. Pillar Cock Super Deluxe with Aerator-15mm (Equivalent to Code No. 508 & Model No. Tropical / Sumthing Special of ESSCO or similar brand)	3				3 00	Each	592.00	1776.00

awagmm
Saw 17/2/26

17/2/26

Sl. No	Chk Lst	Sch. Item	Description of Item	No	L	B	Ht.	Quantity	Unit	Rate	Amount Rs.
38	E5	Page -6 It No - 7(a)(ii) of P W D'S Sanitary Schedule	(ii)Chromium plated Bib Cock long body with wall flange with aerator (Equivalent to Code No. 512 & Model -Tropical / Sumthing Special of ESSCO or similar brand)	7				7 00	Each	659.00	4613.00
-	-										
39	E5	P W D (S&P) 2017 Page -6 It No. -7(b)(ii)	(ii) Chromium plated Concealed Stop Cock (Equivalent to Code No 514(A) & Model - Tropical / Sumthing Special of ESSCO or similar brand)	9				9 00	Each	674.00	6066.00
-	-										
40	E5	Page -29 It No 1 of P W D'S Sanitary Schedule	Supplying, fitting and fixing CPVC (Chlorinated Polyvinyl Chloride) pipes of approved make conforming to IS-15778 :2007 with all necessary accessories, specials viz socket, bend, tee, union, cross, elbo, nipple, longs crew, reducing socket, reducing tee, short piece etc. fitted with holder bats clamps, including cutting pipes, fitting, fixing etc. complete in all respect including cost of all necessary fittings as required, jointing material sinany position above ground (Payment will be made on the centre line measurements of total pipe line including all specials. Nos eparate payment will be made for accesories, specials (a) For exposed work. (i) CPVC pipes Class-1, SDR-II 32mm Dia	4	6 50			26 00	Rm	283.00	7358.00
-	-										
41		Page -29 It No 1 of P W D'S Sanitary Schedule	(a) For exposed work. 25mm Dia (i) CPVC pipes Class-1, SDR-II	6	8 50			51 00	Rm	208.00	10608.00
-	-										
42	E5	P W D (S&P) 2017 Page -29 It No -1. (b)	(b) For concealed work. 15mm Dia (i) CPVC pipes Class-1, SDR-II	7	3 00			21 00	Rm	140.00	2940.00
-	-										
43	E5	Page -5 It No - 5 (vi) of P W D'S Sanitary Schedule	Supplying, fitting and fixing gunmetal wheel valve of approved brand and make tested to 21 kg per sq. cm. (for water lines only) 32 mm dia	2	2 00			4 00	Each	1160.00	4640.00
-	-										
44	M3	PWD S&P-2017, Page -37 It.No 6(b)	Supplying P.V.C. water storage tank of approved quality with closed top with lid (Black) - Multilayer (d) 1000 litre capacity.	1				1 00	Each	5128.00	5128.00
-	-										
45	M3	Sanitary & Plumb 2017 Page-82, Item-22	Supplying, fitting and fixing towel rail with two brackets. C.P. over brass 25mm Dia and 600mm. Long	12				12 00	Each	430.00	5160.00

Signature
17/12/26

Signature
17/12/26

No	Chk Lst	Sch. Item	Description of item	No	L	B	Ht.	Quantity	Unit	Rate	Amount Rs.
46	M3	Sanitary & Plumb 2017 Page-19, Item No. 20	Supply of high density polythene pipe conforming to IS 4984-1985.A) 6Kg/sq cm. (Working pressure)Dia75mm	2	3.00			6.00	Each	248.00	1488.00
47	M3	Sanitary & Plumb 2017 Page-19, Item No. 20	Supply of high density polythene pipe conforming to IS 4984-1985.A) 6Kg/sq cm. (Working pressure)Dia 100mm	2	3.00			6.00	Each	545.00	3270.00
48	M3	P W D (S&P) 2017 P-37 It-10(A)	Labour for hoisting plastic water storage tank. (i) Upto 1500 litre capacity (a) Upto 1st story from G.L	1				1.00	Each	96.00	96.00
49	M4	PWD(W B)- Building Works- P-298 It- 27	Providing and fixing of factory made uPVC Louver window (White Colour) (U value=1.9-1.3 W/m ² K, flame resistant, self extinguishing, lead free) comprising of uPVC multi-chambered with wall thickness of 2.3mm (±0.2 mm) duly reinforced with 1.6 mm (±0.2 mm) thick G. I Section made from roll forming process of required length (shape & size according to uPVC profile). Profile of frame & sash shall be mitred cut and fusion welded at all corners, mullion (if required) shall be also fusion welded including drilling of holes for fixing hardware's and drainage of water etc. Both vertical sides of the frame, adjustable louver mechanism having one lever shall be fitted with the provision of 4 mm glass. Window frame will be fixed to the wall with 100mm long and 8mm dia for fixing frame to finished wall, plastic packers, plastic caps and necessary stainless steel screws etc. Fasteners and after fixing frame the gap between frame and adjacent finished wall shall be filled with weather proof silicon sealant over backer rod of required size, of approved quality complete in all respect as per as per approved drawing & direction of Engineer-in-Charge. a) Louver Window with provision of Exhaust Fan frame of size 67 x 62 mm & Sash / Mullion of size 67 x 78 mm both having wall thickness of 2.3 ± 0.2 mm	10	0.50	0.50		2.50	sqm	7149.00	17872.50
50	M1	PWD(W B)- Building Works- P-198 It- 5	Rendering the Surface of walls and ceiling with White Cement base WATER PROOF wall putty of approved make & brand.(1.5 mm thick	1	11.00	3.20		35.20			
				1	28.40	0.80		22.72			
				1	30.40	4.20		127.68			
	M1		Total					185.60	sqm	122.00	22643.20

Samay
SAB 01/2/26

AEG
17/2/26

No	Chk Lst	Sch. Item	Description of item	No	L	B	Ht.	Quantity	Unit	Rate	Amount Rs.
51	E1	P W D (Bldg) 2017 Page 14 Item No. 1.3rd corr 04.06.2018.p-80.1-1	Supplying and laying true to line and level Anti-Skid, Full Body, Homogeneous & Granular finish Vitrified Tiles conforming to IS 15622-2006 & IS 4457-2007 and testing shall be made in accordance with IS 13630 [Non- modular sizes for tiles with Skid resistance > 0.5, Mohr's hardness > 5.0, Staining resistance: Class-1, Water Absorption: E < 0.5%), MOR > 35 N/sq mm in Internal area of building e.g. Toilet Block, Passage, Corridor, Accessible Open Terrace etc. set in 20 mm sand cement mortar (1:4) and 2 mm thick cement slurry at back side of tiles using cement @ 2.91 Kg./Sqm or using Polymerised Adhesive (6 mm thick layer applied directly over finished artificial stone floor/ Mosaic etc without any backing course) laid after application slurry using 1.75 Kg of cement per Sqm below mortar only, joints grouted with admixture of white cement and colouring pigment to match with colour of tiles/ epoxy grout materials of approved make as directed and removal of wax coating of top surface of tiles with warm water and polishing the tiles using soft and dry cloth upto mirror finish complete including the cost of materials, labour and all other incidental charges complete true to the manufacturer's specification and direction of Engineer-in-Charge (White cement, synthetic adhesive and grout material to be supplied by the contractor) b) In Ground Floor: Sizes-600 mm x600mm x10 mm with breaking strength > 1500 N								
				1	11.00	3.200		35.20			
				1	28.40	0.150		4.26			
				1	2.00	1.500		3.00			
								42.46	sqm	1589.00	67468.94
52	M1	PWD(W B)2017 Building Works P-62 It- 32	Supplying, fitting & fixing granite slabs 15mm to 18 mm. thick with uniform texture & without decorative veins in columns, wall, fascia etc. with 15 mm thick [avg] cement mortar (1:2) including making suitable arrangements to hold the stones properly by brass / copper hooks including pointing in cement mortar (1:2) (1 white cement : 2 marble dust) with admixture of pigment matching the stone shades all complete as per direction of the Engineer-in-charge including cost of all materials, labours, scaffolding, staging ,curing and roughening of concrete surface complete. Area of each Granite slab > 0.6 upto 1.0 square metre. [Using cement slurry at back side of granite @ 4.4 kg/sq m & white cement slurry for joint filling @ 1.8 kg/sq m]								
	-		Inside	3	1.00	0.50		1.50			
	-		out side	2	1.00	1.00		2.00			
	-			3	1.00	0.40		1.20			
	-			2	1.20	1.20		2.88			
	M1		TOTAL					7.58	sqm	2317.00	17562.86

awagmm
Sachin 12/2/26

AE (E)
12/2/26

No	Chk Lst	Sch. Item	Description of item	No	L	B	Ht.	Quantity	Unit	Rate	Amount Rs.
53	M1	Sanitary & Plumb 2017 Page-79, Item No-7	Supplying, fitting and fixing E W C. in white glazed vitreous chinaware of approved make complete in position with necessary bolts, nuts etc.(b) With 'S' trap	2				2.00	Each	1512.00	3024.00
54	M1	Sanitary & Plumb 2017 Page-79, Item No-7	Supplying, fitting and fixing Orissa pattern water closet in white glazed vitreous chinaware of approved make in position complete excluding 'P' or 'S' trap (excluding cost of concrete for fixing) (ii) 530 mm X 410 mm	1				1.00	Each	1522.00	1522.00
55	M1	Sanitary & Plumb 2017 Page-80, Item No-7	Supplying, fitting and fixing Squating plate with integral flushing in white vitreous chinaware of approved make in cement concrete (6:3:1) with jhama chips complete. (Payment of concrete will be paid seperately). (i) 450 mm X 350 mm	1				1.00	Each	881.00	881.00
56		Sanitary & Plumb 2017 Page-80, Item No-7	Supplying, fitting and fixing in position C.I. manhole/ pit cover with rim. (ii) 450 mm X 100 mm X 25 kg (approx)	1				1.00	Each	2035.00	2035.00
57		P W D (Bldg) 6th corr 29.07.2019, p-8,3 New	Supply, fittings, fixing and installation of toilet Cubicles (Nylon) of width and depth as per specifications/site drawings. Cubicles height will be 2003mm made of 12mm th & door 18mm th solid grade compact high pressure laminated as per IS 2046 and EN 438 manufactured under high specific pressure >5 Mpa and temperature >120 degree C with bunch of Kraft paper impregnated with thermosetting phenolic resin and decorative papers made of Alpha cellulose fiber impregnated with thermosetting melamine resin which provide superior scratch, abrasion, heat, chemical, impact, graffiti & moisture resistance along with anti-bacterial properties. Panel have a black core that when machined, presents a distinctive black edge including all necessary accessories made of steel like hinges, screws, door stopper, wall plugs etc & rubber padding as per drawing and direction of Engineering in Charge Toilet Cubicles Std Size (W x D x H) 900mm x 1551mm x 2003mm (Height is including 150mm gap from bottom) Door Width-600mm, Thickness-18mm.	12				12.00	One Cubicles	31206.00	374472.00
58		PWD(W B)2017 Building Works P-169 It- 23(f)	Supplying, fitting & fixing Eco-friendly, Humidity Resistant and Incombustable Light Weight Calcium Silicate board/tiles (Density < 900 Kg per Cu m & Sound absorption NRC - 0.1 to 0.75) Conforming to BS 476 (Part IV, VI & VII) of approved design and brand placed in the grid module of size 600mm X 600mm to form a false ceiling, all complete as per drawing & direction of Engineer - inCharge False ceiling with 15mm X 10mm Densified tegular edged Light weight Calcium Silicate tiles	1	11.00	3.200		35.20	Sqm	847.00	29814.40

Sanjay
17/2/26

AE(C)
17/2/26

No	Chk Lst	Sch. Item	Description of item	No	L	B	Ht.	Quantity	Unit	Rate	Amount Rs.
59		K.M.C. FAIR RATE approved by D.G. (Bustee), dt. 20.10.14	Decorative relief work of artistic nature on exposed surface of cement concrete, plaster or brick work etc. on the surface sketch drawn by artist including preparing the base by rough plaster of sand, cement (1:3) with water proofing compound including oil paint (Two Coats of approved shade, colour over a coat of primer) and applying two coats of decorative cement based paint to the rest portion of the back and other miscellaneous work complete including all materials, labours, scaffolding etc. as per direction of Engineer-in-Charge	1	2.20	2.000		4.40	Sqm	3281.14	14437.02
60		PWD BLDG_SC HD_2017_COR RI_8.3.21 7-30	Supplying, fitting and fixing of 8mm thick high pressured steam cured non asbestos fibre cement board with cellulose fibre manufactured through autoclaving process (conforming to IS 14862-2000, type B category 4) Exterior wall cladding with stone texture in brick pattern finishes of size of 2440X1220 with 6mm thk 50mm wide fillet of fibre cement board with 5mm wide groove at all joint on MS rectangular hollow section of 50mmX 25mm X 2mm thk running vertically @ 600mm c/c fixed on the existing brick wall with the help of base plate of size 100mm X 100mm X 100mm thk grouted with the help of anchor bolt of dia 8mm and MS rectangular hollow section of 50mmX 25mm X 2mm thk welded to the base plate and to the vertical section @ 1200mm c/c. Horizontal bracing of MS rectangular hollow section of 50mmX 25mm X 2mm thk to be welded to the vertical section @ 1200mm section c/c. Horizontal bracing of MS rectangular hollow section of 50mmX 25mm X 2mm thk to be welded to the vertical section @ 1200mm section c/c. Board are to be fixed to the vertical member with the help of 25mm self drilling self tapping full thread steel screw @ 610mm c/c with min distance from the edge 10mm. All the grooves at joint of board should be properly sealed with suitable silicon sealant and finally the exterior grade paint of approved shade to be used on the surface and all the edges of board (payment will be made separately) all complete as per drawing and direction of EIC. (1st Corrigenda & addenda dated 08.01.2018)	1	12.500	4.000		50.00	Sqm	2,338.00	116900.00
61		P.W.D (Bldg) 3rd corr 04.06.2018, p-33,18 New	Supplying, fitting & fixing granite tiles 10mm to 12mm thick in columns, wall, fascia etc. with 15 thick [avg] cement mortar (1:2) including making suitable arrangements to hold the stones properly by brass / copper hooks including pointing in cement mortar (1:2) (1 white cement : 2 marble dust) with admixture of pigment matching the stone shades all complete as per direction of the Engineer-in-charge including cost of all materials, labours, scaffolding, staging, curing and roughening of concrete surface complete. [Using cement slurry at back side of tiles @ 4.4 kg/sq.m & white cement slurry for joint filling @ 1.8 kg/sq.m]	1	11.60	1.000		11.60			
				2	5.20	1.000		10.40			
								22.00	Sqm	1762.00	38764.00
62	A3	PWD(W B)2017-Building Works-P.261 It-9(iv)	Supplying and Planting of different plant / trees (Supplying well grown plants bushy and healthy, minimum height as specified i.e. exposed height including all leads & lift, carriage, handling, manuring, applying pesticide and fertilizer etc. iv) Rangon hi-breed healthy plant.	100				100.00	Each	23.00	2300.00

Signature
17/12/26

Signature
AE (C)
17/12/26

Sl. No	Chk Lst	Sch. Item	Description of item	No	L	B	Ht.	Quantity	Unit	Rate	Amount Rs.
63	A3	PWD(W B)2017- Building Works- P-261 It- 9(vi)	(vi) Duranta healthy plant of big size	97				97.00	Each	25.00	2425.00
64	A1	P W D (S&P) 2017 Page 49, It 1d(ii)	Labour for boring tube well of required dia. by water jet system through any type of soil strata including hire and labour charges for boring pipes, scaffolding, tools and plants as necessary and taking out them and lowering pipes, strainers, blind pipe etc. and fitting and fixing the same complete including bucket washing and other incidental works in the connection. The tube well should have a minimum 50 mm gap in between the outside of the tubewell pipe and the bore. (d) For depth upto 150 metre for 50 mm dia. tube well with top enlargement of 100 mm dia. (ii) 100 mm dia. boring etc. top enlargement								
	A1		Footing	1	32.00			32.00			
			Total					32.00	Metre	426.00	13632.00
65	A1	P W D. (S&P) 2017 Page 49, It 1d(ii)	Labour for boring tube well of required dia. by water jet system through any type of soil strata including hire and labour charges for boring pipes, scaffolding, tools and plants as necessary and taking out them and lowering pipes, strainers, blind pipe etc. and fitting and fixing the same complete including bucket washing and other incidental works in the connection. The tube well should have a minimum 50 mm gap in between the outside of the tubewell pipe and the bore. (d) For depth upto 150 metre for 50 mm dia. tube well with top enlargement of 100 mm dia. (ii) 50 mm dia. boring etc.								
	A1			1	118			118.00	Metre	287.00	33866.00
66	A1	P W D (S&P) 2017 Page 50, It 1 f(i)	Labour for boring tube well of required dia. by water jet system through any type of soil strata including hire and labour charges for boring pipes, scaffolding, tools and plants as necessary and taking out them and lowering pipes, strainers, blind pipe etc. and fitting and fixing the same complete including bucket washing and other incidental works in the connection. The tube well should have a minimum 50 mm gap in between the outside of the tubewell pipe and the bore. (f) For depth more than 150 metre for 50 mm dia. tube well with top enlargement of 100 mm dia. (ii) 50 mm dia. boring etc. beyond 150 metre								
	A1			1	85.00			85.00			
67	E7	M I C Item M- 46.4 Dated 23.06.2017	Carrying etc Store Material Viz Pipe, Strainer, Pump Etc. From from store to work site. (i) For depth upto 100M					85.00	Metre	216.00	18360.00
	E7			1				1.00			
68	M7	P W D (S&P) 2017 Page 55, It 23	Collecting sample of water for bacteriological and chemical test from any depth at any time during execution of work including hire and labour charges for tools and plants and sterilising the equipments, paying all charges and fees, testing etc. complete in all respect as per direction.					1.00	Lump Sum	1097.25	1097.25

Handwritten signature and date: 17/12/24

Handwritten signature and date: 17/12/24

No	Chk Lst	Sch. Item	Description of item	No	L	B	Ht.	Quantity	Unit	Rate	Amount Rs.
			outside	1				1.00			
	M7							1.00	Lump Sum	1231.00	1231.00
69	M7	P.W.D. (Bldg) 2017 Page 1. Item No. 1	Earthwork in excavation of foundation trenches or drains in all sorts of soil (including mixed soil but excluding laterite or sand stone) including removing, spreading or stacking the spoils within a lead of 75m as directed. The item includes necessary trimming the sides of trenches levelling dressing and ramming the bottom bailing out water as required complete. Depth of excavation not exceeding 1500 mm.								
				1	2.00	2.000	0.600	2.400			
	M7							2.400	%Cum	11927.00	286.25
70	E7	P.W.D. (Bldg) 2017 3rd corr 04.06.2018,p-1	Single brick flat soling of picked jhama bricks including ramming and dressing bed to proper level and filling joints with powdered earth or local sand.								
				1	2.00		2.000	4.000			
	E7		Total					4.000	Sqm	361.00	1444.00
71	E7	P.W.D. (Bldg) 2017,3rd corr 04.06.2018,p-10	Cement concrete with graded jharma khoa (30 mm. size) excluding shuttering in ground floor and foundation. a) 1:3:6 Proportion								
				1	2.00	2.00	0.100	0.4000			
	E7							0.400	Cum	4761.00	1904.40
72	E7	P.W.D. (Bldg) 2017 3rd corr 04.06.2018,p-3,i-8	125 mm. thick brick work with 1st class bricks in cement mortar (1:4) in ground floor.								
				1	6.00	0.6000		3.60			
	E7		Total					3.60	sqm	736.00	2649.60
73	A1	P.W.D. (Bldg) 2017 3rd corr 04.06.2018,p-23,i-4(ii)	Artificial stone in floor, dado, staircase etc with cement concrete (1:2:4) with stone chips, laid in panels as directed with topping made with ordinary or white cement (as necessary) and marble dust in proportion (1:2) including smooth finishing and rounding off corners including raking out joints or roughening of concrete surface and application of cement slurry before flooring works using cement @ 1.75 kg/sq m all complete including all materials and labour. In ground floor, 3 mm. thick topping (High polishing grinding on this item is not permitted with ordinary cement). Using grey cement								
				1	2.00	2.00		4.00			
								4.00	sqm	273.00	1092.00
74	A1	P.W.D. (Bldg) 2017,3rd corr 04.06.2018.p-50,i-1	Plaster (to wall, floor, ceiling etc.) with sand and cement mortar including rounding off or chamfering corners as directed and raking out joints including throating, nosing and drip course, scaffolding/staging where necessary (Groundfloor). (i) With 1:4 cement mortar C) 15 mm thick plaster (internal)								

Amayam
10/1/26

AEI
17/2/26

No	Chk Lst	Sch. Item	Description of item	No	L	B	Ht.	Quantity	Unit	Rate	Amount Rs.
-	A1			1	6.00	1.20		7.20			
75	-	P.W.D (Bldg) 2017, p-192, I-15	Neat cement punning about 1.5mm thick in wall, dado, window sill, floor etc. NOTE: Cement 0.152 cu m per 100 sq.m.	Total				7.20	Sqm	167.00	1202.40
-	A1			1	6.00	1.200		7.20			
76	E1	P.W.D (Bldg) 2017, 3rd corr 04 06 2018, p-10, I-27	Ordinary Cement concrete (mix 1:2:4) with graded stone chips (20 mm nominal size) excluding shuttering and reinforcement, if any, in ground floor as per relevant IS codes.					7.20	Sqm	34.00	244.80
-	E1			Total	1	2.00	2.0000	0.4000			
-								0.4000	Sqm	4060.00	1624.00
77	E7	UDMA WATER SUPPLY WORKS WEF_0 51018 4-11 ii	Supplying sign-board made of 25 mm thick sal plank with frame on all side of sal batten 50 mm x 32 mm with nailed on post 3.15m x 100mm x 100mm and fitting fixing such with digging holes of dia 300 mm and depth 750 mm in all sorts of soil and repacking and consolidating the gap around the post with cement concrete (1 : 3 : 6) painting 2 coats including cost of nails, bolts and nuts etc. complete in all respect as per direction of the Engineer-in-charge. Payment of concrete and painting to be made separately (ii) 900 mm. x 600 mm. size of board.								
-	E7			Front area	1			1.00			
-				Total				1.00	Each	813.00	813.00
78	M4	UDMA WATER SUPPLY WORKS WEF_0 51018 3-11	Hire and labour charges for coir rope fencing 25 mm dia rope single on 120 mm dia bamboo posts 1.40 m above G.L and 600 mm below G.L, 1.50 m apart including digging holes complete.								
-	M4			Total	4	8.00		32.00			
-								32.00	Metre	17.00	544.00
79	M6	UDMA WATER SUPPLY WORKS WEF_0 51018 2-15	Cutting & picking up existing metallised black top portion of road surface to an average depth of 300 mm by using Jack hammer with all necessary tool and plant including reneing the serviceable materials & stacking within a lead of 75 mtr. all complete as per direction of the Engineer-inCharge.								
-	M6				1	2.00	2.00	0.10	0.40		
-								0.40	Cum	636.00	254.40

Handwritten signature

Handwritten signature

No	Chk Lst	Sch. Item	Description of item	No	L	B	Ht.	Quantity	Unit	Rate	Amount Rs.
80	M6	P.W.D. (Bldg) 2017,5th Corr.16.04.2019 Page 2, Item 1	Filling in foundation or plinth by silver sand in layers not exceeding 150 mm. As directed and consolidating same by thorough saturation with water ramming complete including the cost of supply of sand. (Payment to be made on measurement of finished quantity)								
	M6			1	2.00	2.00	0.15	0.600	%Cum	131714.00	790.28
81	M6	UDMA WATER SUPPLY WORKS WEF_0 51018 3-1 14	Signalling arrangement at both sides of site to avoid any accident during working period 4 nos. red flags during sunlight at 4 corners and 2 nos light (lamp) in other than sunlight.								
	M6			6				6	Day	202.00	1212.00
82	M6	UDMA WATER SUPPLY WORKS WEF_0 51018 3-1 13	Hire & labour charges for diesel generating set for lighting including fuel,300M wire, 11 points with 200 Watt bulb with post for hanging & maintaining the same for day & night for the period.					6	Day	202.00	1212.00
	M6			6				6			
			Total					6	Day	1650.00	9900.00
83	-	PWD SANITARY AND PLUMBING 2017 102-C C II 1 e(ii)	Supply of G. I. pipes of TATA make including necessary sockets (f) 50 mm dia. (ii) Medium quality								
	E1			1	225.00			225.00			
								225.00	Metre	402.00	90450.00
84	-	PWD SANITARY AND PLUMBING 2017 102-C C II 1 (ii)	Supply of G. I. pipes of TATA make including necessary sockets (i) 100 mm dia (ii) Heavy quality								
	E1			1	32.00			32.00	Metre	983.00	31456.00
85	-	UDMA WATER SUPPLY WORKS WEF_0 51018 4-1 18	Removal of rubbish, earth etc. from the working site and disposal of thesame beyond the compound, in conformity with the Municipal / Corporation Rules for such disposal, loading into truck and cleaning thesite in all respect as per direction of Engineer in charge.								
					30*3 14=94.2			94.2			
					70*3 14=219.8			219.8			
				1	2.45	0.10	0.10	0.023			

Handwritten signature and date: 17/2/26

Handwritten signature and date: 17/2/26

Sl. No	Chk Lst	Sch. Item	Description of item	No	L	B	Ht.	Quantity	Unit	Rate	Amount Rs.
								2.20	Cum	166.00	365.70
86	E1	AS PER RATE APPROVED BY MUNICIPAL COMMISSIONER DATED 24.01.2019.	SUPPLY OF KSB MAKE SUBMERSIBLE PUMP MOTOR SET TYPE CORE 4C/8, 1 HP 220 VOLT WITH 1 5 INCH (40 MM) DIA DELIVERY OUTLET INCLUDING 1 HP CONTROL PANEL AND 1 5 SQ MM. 3 CORE CABLE OF 40 MTR LENGTH.								
				1				1.00			
								1.00	Each	21918.00	21918.00
TOTAL											1966906.45
Add 18% G.S.T= Rs.											354043.16
Total											2320949.61
Add 1% labour welfare cess											23209.50
Gross Total											2344159.00

[Handwritten Signature]
17/2/26

[Handwritten Signature]
AFC
17/2/26

[Handwritten Signature]
17.02.26

Executive Engineer (Civil)
Uttaran Services Department
K. M. C.

[Handwritten Signature]
17/02/26
Dy. Chief Engineer (Civil)
Uttaran Services Department
K. M. C.

[Handwritten Signature]
17/2/26
D. G.
Uttaran Services Department
K. M. C.