

NAME OF WORK:- ESTIMATE FOR ELECTRICAL WORK OF 12 SEATED PUBLIC TOILET AT KANKONA BAOR GHAT WARD NO. - 11 UNDER - GOBARDANGA MUNICIPALITY OF WEST BENGAL (MODEL NO - D) [ASPIRATIONAL PARAMETER]

\* As per PWD & I & WD schedule district charges will be applicable on PWD & I & WD schedule items

\* No district charges will be applicable on non-schedule items

Sl No.	Item Description	Unit	Quantity	Rate	Amount	Remarks
1	Distribution wiring in 2 x 22/0.3 (1.5 sqmm) single core stranded 'FR' PVC insulated & unsheathed copper wire (Brand approved by EIC) in 20 mm size PVC rigid conduit 'FR' (Precision make), with 1x22/0.3 (1.5 sqmm) single core stranded 'FR' PVC insulated & unsheathed copper wire for ECC, to light/fan/call bell points with Piano Key type switch fixed on MS CRC sheet metal (16 SWG) switch board cum JB on wall complete with 2 no. suitable size "Ph & N" copper bar incl. bakelite/Perspex (wall matching color) top cover 3 mm thick and incl. 175mmx100mmx65mm inspection box. making earthing attachment, painting the MS box and mending good the damages to original finish. [PWD Schedule Page No-E-14 Item No-2a]	Point	<del>27</del> 34	612.00	<del>22644.00</del> 20808.00	ADD DISTRICT CHARGES
	Average run 5 mtr					
2	Distribution wiring in 1.1 KV grade 22/0.3 (1.5 sqmm) single core stranded 'FR' PVC insulated & unsheathed copper wire (Brand approved by EIC) in 20mm size PVC rigid conduit 'FR' (Precision make), with 1.1 KV grade 1 x 22/0.3 (1.5 sqmm) single core stranded 'FR' PVC insulated & unsheathed copper wire as ECC, to 5A 3 pin flush type plug socket & Piano Key type switch fixed on MS CRC sheet metal (16 SWG) switch board cum JB on wall incl. bakelite/Perspex (wall matching color) top cover 3 mm thick and incl. painting the MS box and mending good the damages to original finish On Board only for pay counter) [PWD Schedule Page No-E-15; I-4a]	Point	1	67.00	67.00	ADD DISTRICT CHARGES
3	Supplying and fixing 240V 32A Double Pole AC Type 30mA RCCB.(Complete Set) (ISI marked) [Make- Legrand] (Cat No 4113/95) [Legrand Page No-92]	Nos	1	5942.00	5942.00	NO DISTRICT CHARGES
4	Distribution wiring in 1.1 KV single core stranded 'FR' PVC insulated & unsheathed copper wire (Brand approved by EIC) in 20mm size PVC rigid conduit 'FR' (Precision make) incl. necy. fittings as required 2 x 36/0.3 (2.5 sqmm) + 1 x 22/0.3 (1.5 sqmm) ECC [PWD Schedule Page No-E-14 Item No-	mtr	35	119.00	4165.00	ADD DISTRICT CHARGES

Sub-Assistant Engineer  
Gobardanga Municipality  
North 24 Parganas



5	Supplying and fixing double-door SPN MCB Distribution Board with IP-42/43 protection. concealed in wall after cutting the wall & mending good the damages to original finish incl. Inter connect on with suitable size of copper wire and neutral link & provision for earthing attachment. a) For (2+ way) (Make - Havells) [PWD Schedule Page No-D-9;Item No-13]	No	1	1073.00	1073.00	ADD DISTRICT CHARGES
6	Supplying and fixing 240/415 V MCB of Breaking capacity 10kA & C characteristics on din rail of existing DBs and necessary connection 6-32A SP MCB (Make -Havells) [PWD Schedule Page No-D-6;Item No-7]	Nos	6	168.00	1008.00	ADD DISTRICT CHARGES
7	Supplying and fixing 240/415 V MCB Isolator on din rail of existing DBs and necessary connection 40A DP MCB Isolator (Make -Havells) [PWD Schedule Page No-D-5;Item No-6]	Nos	1	208.00	208.00	ADD DISTRICT CHARGES
8	Supply of TMC501 conventional industrial batten (Philips make) LED Tube. model no- TMC501 P1x1-LED 2'W P3241 (WB I & WD schedule P-113, I- 5:3 F.22)	Nos	9	451.00	4059.00	ADD DISTRICT CHARGES
9	Fixing only single/twin fluorescent light fitting complete with all accessories directly on wall/ceiling by screws etc.. [PWD Schedule Page No-C-2;Item No-14a]	Nos	9	86.00	774.00	ADD DISTRICT CHARGES
10	Supply & fixing Bulk head light fittings with die cast aluminium housing frosted/clear glass on wall/ceiling incl S/F 9 watt LED Lamp complete set. [Make - Havells] (PWD sch - Page--D-13, I-23)	Nos	<del>17</del> 15	654.00	<del>11118.00</del> 9810.00	ADD DISTRICT CHARGES
11	Supply & fixing smart bright street light complete with all accessories to be fixed from the wall of building or on pole incl. making holes /providing clamping arrangement & neey. GI reducer as required.S&F 40 mm GI Pipe 1.5 mtr average length & s&f neey length of 1.5 sqmm pvc insulated single core copper wire & making connections as required & mending good damages incl.wall paingting. (30 Watt) (Make - Bajaj) [WB I&WD sch P-111, I-19.0.2]	Nos	2	3016.00	6032.00	ADD DISTRICT CHARGES
12	Supply of 12" domestic metal exhaust fan 12" 230V 50 Hz SWEEP. TRANS AIR - ( Make-Crompton/Havell/Bajaj) (UD & MA schedule P-14. I-5)	Nos	<del>7</del> 6	2093.00	<del>14651.00</del> 12558.00	NO DISTRICT CHARGES
13	Fixing only exhaust fan after making hole in wall and making good damages and smooth cement finish etc. as practicable as possible and providing neey. length of PVC insulated wire and making connection for exhaust of following diameter: 30 cm ( 12" )  [PWD Schedule Page No-C-4;iteam No-28(b)]	Nos	<del>7</del> 6	329.00	<del>2303.00</del> 1974.00	ADD DISTRICT CHARGES

  
 Sub-Assistant Engineer  
 Gobardanga Municipality  
 North 24 Parganas



14	Fixing only cover shutter/cowl on wall with neey bolts & nuts (6 mm dia x 62 mm long) For 30 cm(12") Exhaust fan  [PWD Schedule Page No-C-4;Item No-30(b)]	Nos	6	110.00	<del>770.00</del> 660.00	ADD DISTRICT CHARGES
15	S/F 240V 25A Modular type starter (brand approved by EIC)with 25 A. Modular switch DP MCB (C-Curve)and 4 Module G.I. Modular type switch board with 4 Modul. Top Cover Plate flushed in wall incl. S/F switch board and Cover Plate and making neey. Connections with PVC Copper wire and earth connectivity wire etc. as per schedule (for Pump) [PWD Schedule Page No-E-19, Item No-17] (Please follow in details)	Nos	1	784.00	784.00	ADD DISTRICT CHARGES
16	Supply of 240V A.C Ceiling Fan ( 48" sweep, 1200 mm complete) [Make-Crompton [ for counter only] (UD & MA schedule P- 23, I- 70)	Each	1	2283.00	2283.00	NO DISTRICT CHARGES
17	Fixing only Ceiling Fan [PWD sch P- C-3, I-21(a)]	Each	1	66.00	66.00	ADD DISTRICT CHARGES
18	Supply & Fixing 240 V. 16/20 A Piano key type switch (Brand approved by EIC) on sheet metal switch board incl. S & F 100x100x65mm MS (16SWG) switch board and bakelite/perspex top cover of 3mm thick by Brass screws after making housing for switch by cutting bakelite/perspex cover and making necessary connections as required. (For Hand Dryer machine) [PWD sch P- E-6, I-17(b)]	Each	2	201.00	402.00	ADD DISTRICT CHARGES
19	Supply and Fixing of 2 mm Polyvinyl glow sign board made of 22 SWG GI sheet box with 1"X1" aluminum channel for fixing the vinyl board after necessary cutting the letter as required & s/f LED tube light fittings along with all accessories. (16 sqft @495.10 sqft) (UD & MA schedule P-14, I-4)	Nos	1	7920.00	7920.00	NO DISTRICT CHARGES
20	Earthing installation by GI earth Spike (1830 X 20 mm) including 8SWG GI EarthWire & GI nuts, bolts, washer etc.	Nos	1	450.00	450.00	NO DISTRICT CHARGES
				Total	86549.00	81043.00
				Add 18% GST	15578.82	14587.74
				Total With GST (A)	102127.82	95630.74
				Cess @ 1%	1021.27	956.30
				total	103149.09	96587.04
Contingency Amount on "A"				Contingency @ 3%	3063.83	2868.92
(Total+GST)=Rs:				Total	106212.92	99455.96
				Say Rs.	106213.00	99456.00

RUPEES ~~ONE LAKH SIXTY FOUR THOUSAND TWO HUNDRED AND THIRTEEN ONLY.~~

Say Rs. 99,456.00

Sub-Assistant Engineer  
Gobardanga Municipality  
North 24 Parganas



Chairman  
Gobardanga Municipality  
North 24 Parganas

MODLE DRAWING FOR CONSTRUCTION OF C. T./P.T.  
 TOILET SEAT 12 NOS, URINAL 18 NOS  
 MODLE NO.- D

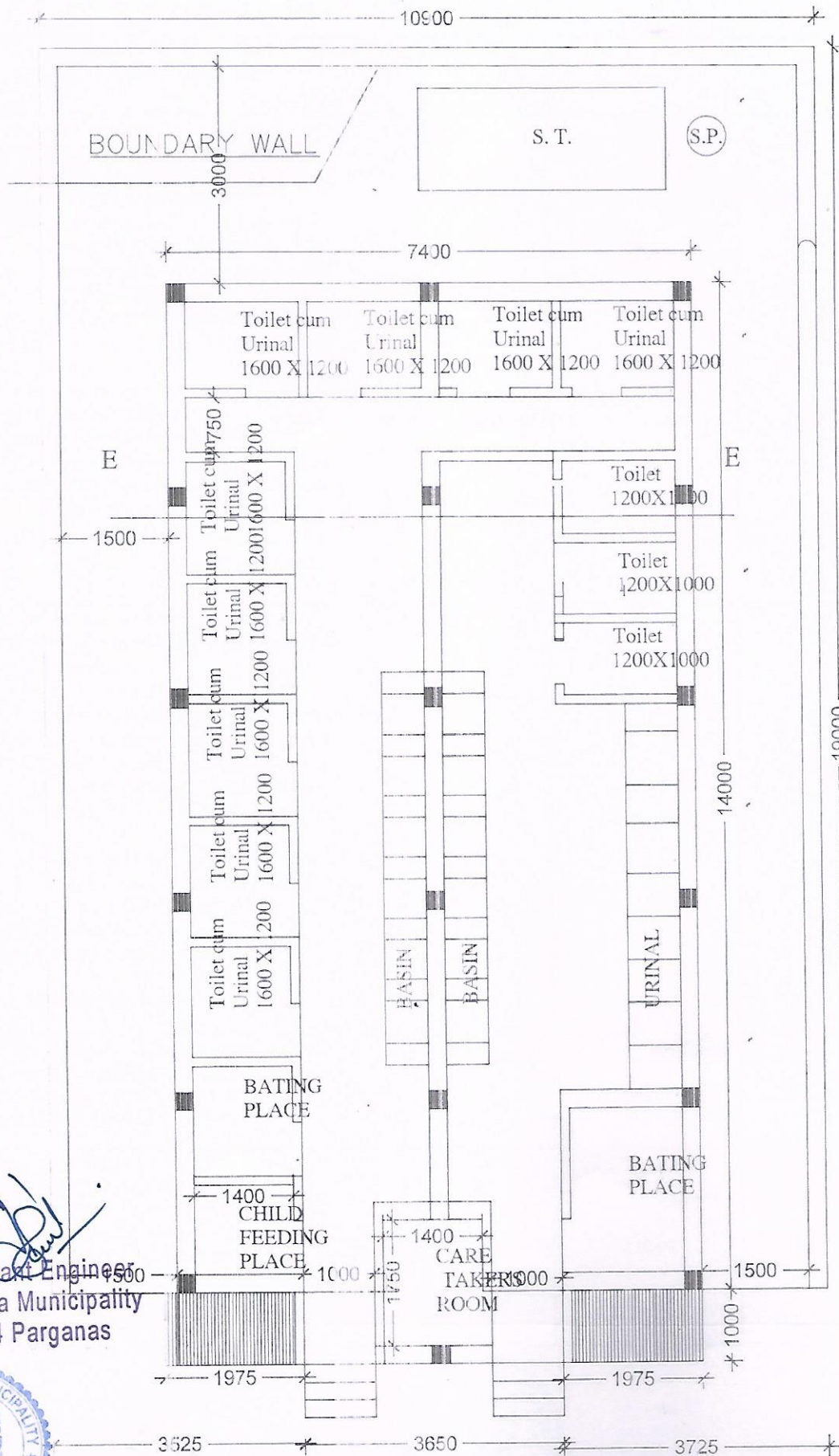

BHLP → 15  
 TL → 09  
 EF → 06  
 OL → 02  
 CF → 01  
 GSB → 01

34 pts

Sub-Assistant Engineer  
 Gobardanga Municipality  
 North 24 Parganas



DI ANI

Chairman  
 Gobardanga Municipality  
 North 24 Parganas