

NAME OF WORK:- ESTIMATE FOR ELECTRICAL WORK OF 2 SEATED PUBLIC TOILET FOR SCHOOL STUDENTS AT BAGHAJATIN SSK WARD NO. - 07 UNDER TAHERPUR NAA OF WEST BENGAL [ASPIRATIONAL PARAMETER] (MODEL NO-CT-1)



\* As per PWD & I & WD schedule of 2022 & 3% district charges applicable on PWD & I & WD schedule items

\* No district charges will be applicable on non-schedule items

| Sl No. | Iteam Description   | Unit  | Quantity | Rate    | Amount  | Remarks              |
|--------|---|-------|----------|---------|---------|----------------------|
| 1      | Distribution wiring in 2 x 22/0.3 (1.5 sqmm) single core stranded 'FR' PVC insulated & unsheathed copper wire (Brand approved by EIC) in 20mm size PVC rigid conduit 'FR' (Precision make), with 1x22/0.3 (1.5 sqmm) single core stranded 'FR' PVC insulated & unsheathed copper wire for ECC, to light/fan/call bell points with Piano Key type switch fixed on MS CRC sheet metal (16 SWG) switch board cum JB on wall complete with 2 no. suitable size "Ph & N" copper bar incl. bakelite/Perspex (wall matching color) top cover 3 mm thick and incl. 175mmx100mmx65mm inspection box, making earthing attachment, painting the MS box and mending good the damages to original finish.<br>[PWD Schedule Page No-E-14 Iteam No-2a] | Point | 12       | 630.36  | 7564.32 | ADD DISTRICT CHARGES |
|        | Average run 5 mtr   |       |          |         |         |                      |
| 2      | Distribution wiring in 1.1 KV grade 22/0.3 (1.5 sqmm) single core stranded 'FR' PVC insulated & unsheathed copper wire (Brand approved by EIC) in 20mm size PVC rigid conduit 'FR' (Precision make), with 1.1 KV grade 1 x 22/0.3 (1.5 sqmm) single core stranded 'FR' PVC insulated & unsheathed copper wire as ECC, to 5A 3 pin flush type plug socket & Piano Key type switch fixed on MS CRC sheet metal (16 SWG) switch board cum JB on wall incl. bakelite/Perspex (wall matching color) top cover 3 mm thick and incl. painting the MS box and mending good the damages to original finish<br><b>On Board (only for pay counter)</b><br>[PWD Schedule Page No-E-15; I-4a]  | Point | 1        | 69.01   | 69.01   | ADD DISTRICT CHARGES |
| 3      | Supplying and fixing 240V 32A Double Pole AC Type 30mA RCCB.(Complete Set) (ISI marked) [Make- Legrand] (Cat No 4113/95) [ Legrand Page No-92 ]   | Nos   | 1        | 5942.00 | 5942.00 | NO DISTRICT CHARGES  |

|    |   |     |    |         |         |                      |
|----|---|-----|----|---------|---------|----------------------|
| 4  | Distribution wiring in 1.1 KV single core stranded 'FR' PVC insulated & unsheathed copper wire (Brand approved by EIC) in 20mm size PVC rigid conduit 'FR' (Precision make) incl. necy. fittings as required 2 x 36/0.3 (2.5 sqmm) + 1 x 22/0.3 (1.5 sqmm) ECC<br>[PWD Schedule Page No-E-14 Iteam No-1a(ii)]   | mtr | 10 | 122.57  | 1225.70 | ADD DISTRICT CHARGES |
| 5  | Supplying and fixing double-door SPN MCB Distribution Board with IP-42/43 protection, concealed in wall after cutting the wall & mending good the damages to original finish incl. Inter connection with suitable size of copper wire and neutral link & provision for earthing attachment.<br>a) For (2+4 way) (Make -Havells)<br>[PWD Schedule Page No-D-9;Iteam No-13]   | No  | 1  | 963.05  | 963.05  | ADD DISTRICT CHARGES |
| 6  | Supplying and fixing 240/415 V MCB of Breaking capacity 10kA & C characteristics on din rail of existing DBs and necessary connection 6-32A SP MCB (Make -Havells)<br>[PWD Schedule Page No-D-6;Iteam No-7]   | Nos | 4  | 173.04  | 692.16  | ADD DISTRICT CHARGES |
| 7  | Supplying and fixing 240/415 V MCB Isolator on din rail of existing DBs and necessary connection.<br>40A DP MCB Isolator (Make -Havells)<br>[PWD Schedule Page No-D-5;Iteam No-6]   | Nos | 1  | 214.24  | 214.24  | ADD DISTRICT CHARGES |
| 8  | Supply of TMC501 conventional industrial batten (Philips make) LED Tube,model no-TMC501 P1xT-LED 22W P3241 (WB I & WD schedule P-113, I- 5:3 F.22)  | Nos | 3  | 464.53  | 1393.59 | ADD DISTRICT CHARGES |
| 9  | Fixing only single/twin fluroscnt light fitting complete with all accessories directly on wall/ceiling by screws etc..<br>[PWD Schedule Page No-C-2;Iteam No-14a]   | Nos | 3  | 88.58   | 265.74  | ADD DISTRICT CHARGES |
| 10 | Supply & fixing Bulk head light fittings with die cast aluminium housing frosted/clear glass on wall/ceiling incl S/F 9 watt LED Lamp complete set. [Make - Havells]<br>(PWD sch - Page--D-13, I-23)  | Nos | 3  | 671.37  | 2014.11 | ADD DISTRICT CHARGES |
| 11 | Supply & fixing smart bright street light complete with all accessories to be fixed from the wall of building or on pole incl. making holes /providing clamping arrangement & necy. GI reducer as required.S&F 40 mm GI Pipe 1.5 mtr average length & s&f necy length of 1.5 sqmm pvc insulated single core copper wire & making connections as required & mending good damages incl wall paingting. (30 Watt) (Make -Baja)<br>[WB I&WD sch P-111, I-f.9.0.2] | Nos | 1  | 3106.48 | 3106.48 | ADD DISTRICT CHARGES |



|    |  |      |   |         |         |                            |
|----|--|------|---|---------|---------|----------------------------|
| 12 | Supply of 9" domestic metal exhaust fan<br>9" (225mm)SWEEP. TRANS AIR -<br><b>( Make-Crompton/Havells/Bajaj )<br/>(UD &amp; MA schedule P-14, I-5))</b>  | Nos  | 3 | 1863.00 | 5589.00 | NO DISTRICT<br>CHARGES     |
| 13 | Fixing only exhaust fan after making hole in wall<br>and making good damages and smooth cement<br>finish etc. as practicable as possible and<br>providing necy. length of PVC insulated wire and<br>making connection for exhaust of following<br>diameter:<br>22.5 cm ( 9" )<br><b>[PWD Schedule Page No-C-4;Iteam No-28(b)]</b>  | Nos  | 3 | 254.41  | 763.23  | ADD DISTRICT<br>CHARGES    |
| 14 | Fixing only louver shutter/cowl on wall with<br>necy. bolts & nuts<br>(6 mm dia x 62 mm long)<br>For 22.5 cm(9") Exhaust fan<br><b>[PWD Schedule Page No-C-4;Iteam No-30(b)]</b>   | Nos  | 3 | 84.46   | 253.38  | ADD<br>DISTRICT<br>CHARGES |
| 15 | Supply of 240V A.C Ceiling Fan ( 48"<br>sweep,1200 mm complete)<br><b>[Make-Crompton [ for counter only ]<br/>(UD &amp; MA schedule P- 23, I- 70)</b>  | Each | 1 | 2283.00 | 2283.00 | NO DISTRICT<br>CHARGES     |
| 16 | Fixing only Ceiling Fan<br><b>[PWD sch P- C-3, I-21(a)]</b>  | Each | 1 | 67.98   | 67.98   | ADD<br>DISTRICT<br>CHARGES |
| 17 | Supply & Fixing 240 V, 16/20 A Piano key type<br>switch (Brand approved by EIC) on sheet metal<br>switch board incl. S & F 100x100x65mm MS<br>(16SWG) switch board and bakelite/perspex top<br>cover of 3mm thick by Brass screws after<br>making housing for switch by cutting<br>bakelite/perspex cover and making necessary<br>connections as required.<br>(For Hand Dryer machine)<br><b>[PWD sch P- E-6, I-17(b)]</b>                                     | Each | 1 | 207.03  | 207.03  | ADD<br>DISTRICT<br>CHARGES |
| 18 | S/F 240V 25A Modular type starter (brand<br>approved by EIC)with 25 A. Modular switch DP<br>MCB (C-Curve)and 4 Module G.I. Modular type<br>switch board with 4 Module Top Cover Plate<br>flushed in wall incl. S/F switch board and Cover<br>Plate and making necy. Connections with PVC<br>Copper wire and earth connectivity wire etc. as<br>per schedule <b>[for Pump]</b><br><b>[PWD Schedule Page No-E-19, Item No-17]<br/>(Please follow in details)</b> | Nos  | 1 | 807.52  | 807.52  | ADD<br>DISTRICT<br>CHARGES |
| 19 | Supply and Fixing of 2 mm Polyvinyl glow sign<br>board made of 22 SWG GI sheet box with 1"X1"<br>aluminum channel for fixing the vinyl board<br>after necessary cutting the letter as required & s/f<br>LED tube light fittings along with all<br>accessories. (16 sqft @495.00/sqft)<br><b>(UD &amp; MA schedule P-14, I-4)</b>   | Nos  | 1 | 7920.00 | 7920.00 | NO DISTRICT<br>CHARGES     |



|    |  |     |                    |        |          |                     |
|----|--|-----|--------------------|--------|----------|---------------------|
| 20 | Earthing installation by GI earth Spike (1830 X 20 mm) including 8SWG GI EarthWire & GI nuts, bolts, washer etc. | Nos | 1                  | 450.00 | 450.00   | NO DISTRICT CHARGES |
|    |  |     | Total              |        | 41791.54 |                     |
|    |  |     | Add 18% GST        |        | 7522.48  |                     |
|    |  |     | Total With GST (A) |        | 49314.02 |                     |
|    |  |     | Cess@1%            |        | 493.14   |                     |
|    |  |     | total              |        | 49807.16 |                     |
|    | Contingency Amount on "A"  |     | Contingency@3%     |        | 1479.42  |                     |
|    | (Total+GST)=Rs:  |     | Total              |        | 51286.58 |                     |
|    |  |     | Say Rs.            |        | 51287.00 |                     |
|    | Service Connection Charges as per Quotation  |     |                    |        |          |                     |



*[Signature]*  
Sub-Assistant Engineer  
Taherpur Notified Area Authority  
Taherpur, Nadia

*[Signature]*  
Executive Officer  
Taherpur Notified Area Authority  
Taherpur, Nadia

*[Signature]*  
Chairman  
Taherpur Notified Area Authority  
Taherpur, Nadia

Technically Vetted Rs.: 51,287.00  
(Rupees Fifty one thousand two hundred eighty seven only.)

*[Signature]* 24.09.25  
Junior Engineer  
Electrical & Mechanical Division  
SUDA

*[Signature]* 24.9.25  
ASSISTANT ENGINEER  
ELECTRICAL & MECHANICAL DIVISION  
SUDA

*[Signature]* 24/9/25  
Executive Engineer (E/M)  
O/O the Secretary M.E. Dte.  
Government of West Bengal



Bulk Head Light - 03

Exhaust Fan - 01

Tube Light - 01

Glow Sign Board - 01

Out Door Street Light - 01

Pump - 01

Total - 08 Point

Sub-Assistant Engineer  
Taherpur Notified Area Authority  
Taherpur, Nadia

*[Signature]*

Executive Officer  
Taherpur Notified Area Authority  
Taherpur, Nadia

*[Signature]*

Chairman  
Taherpur Notified Area Authority  
Taherpur, Nadia

*[Signature]*

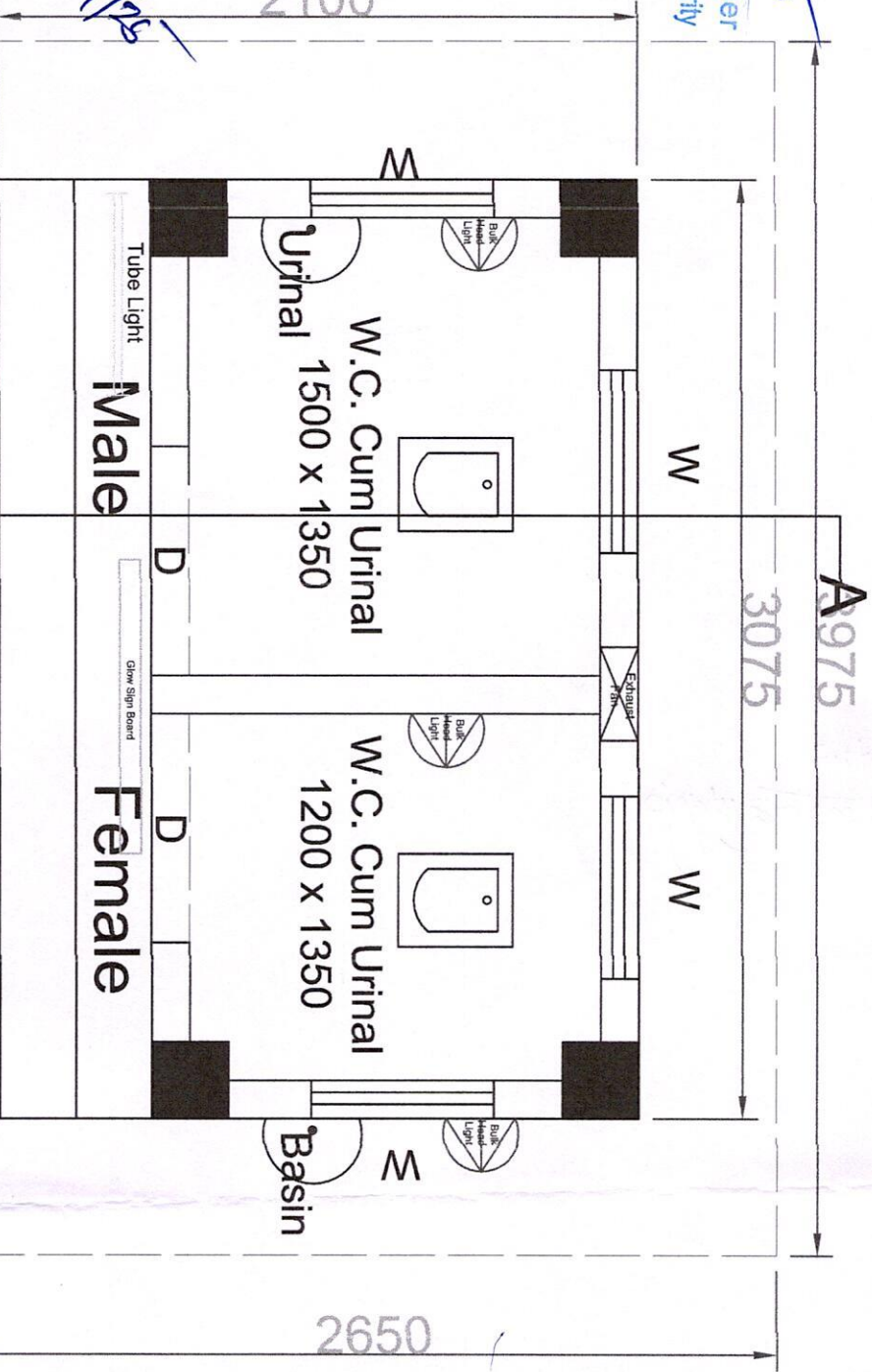

Model Plan No. - CT-1-Electrical