

PT/14/11

Sketch Map for Public L.T

Mauza - Bara

J.L. NO - 26

L.R. Plat NO - $\frac{650}{1021}$ (vest land)

At- Sasti Tala

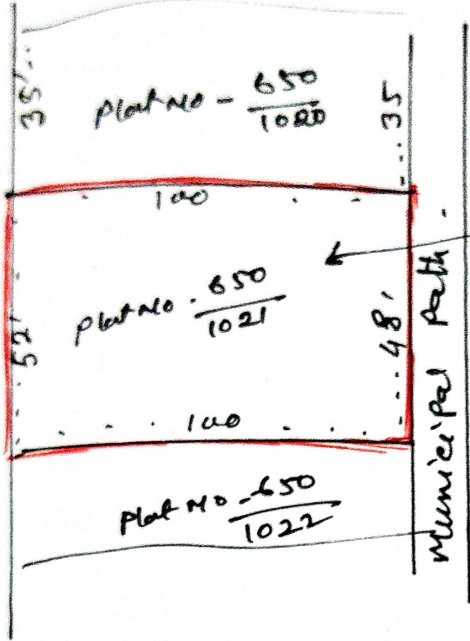

Proposed Area



Drawn by
Joydip Ghosh

East India Technical &
Commercial Survey, Ser. No-6833
Dainnat, Burdwan