

Annexure-III

Site Inspection Report for construction of CT/PT

Date : 16/12/2024

Ward No	Dinhata	
Name of the proposed site	5 Gyonada Devi High School	
Address	Jamtala	
Category CT/PT	PT	
Necessary Land Details	Whether the Land is belongs to the ULB/Other (If Other please specify)	School
	Dag No., Khatian No., J.L. No. & other plot information.	JL NO-108 Plot No-7313
	No objection Certificate received from the concerned authority (Yes/No)	Yes(form School)
Nearest location of CT/PT	N/A	
Proposed no of Toilet seats	Male	1
	Female	1
Proposed no of Urinal seats	Male	2
	Female	1
To be constructed as Aspirational Toilet or Normal Toilet (only applicable for PTs)	Aspirational/Normal Normal	
Area required for Public Toilets	4 to 5 sq. meters per 10 toilet seats: Min. 1.5 m x 1.2 m	5M X 4.5M (Model-F)
Area requirement details in sq mm for Community Toilets	Toilet Cubical (Optimum=900x1200, Minimum=750x900)	
	Urinal (Minimum=500x600)	
Space identified for installation of Soakpit and Soak Well	Yes	
Availability of surface water/piped water supply (in details)	Piped Water	
Operation and Maintenance plan in detail	School Authority	
Remarks if any:		
Representative assigned from Hijli Inspiration for the site inspection	Name & Designation	Dibyendu Bhattacharjee (Coordinator) & Abhik Majumdar(Engr)
	Contact No	9932204505 & 9851301709
	Signature with Seal	<i>[Signature]</i> <i>[Signature]</i>
Representative assigned from the ULB for the site inspection	Name & Designation	Hari Barman (SAE)
	Contact No	9733078191
	Signature with Seal	<i>[Signature]</i> Sub Assistant Engineer Dinhata Municipality

Sub Assistant Engineer
Dinhata Municipality

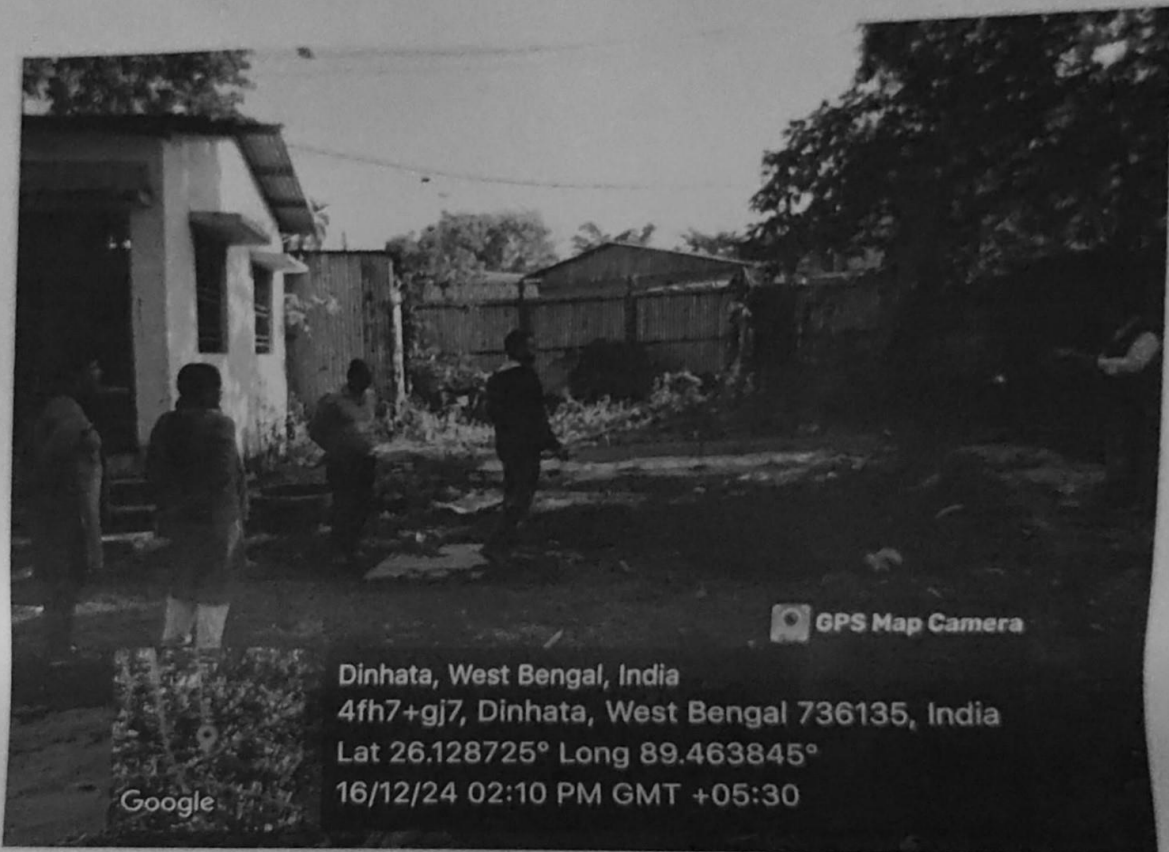
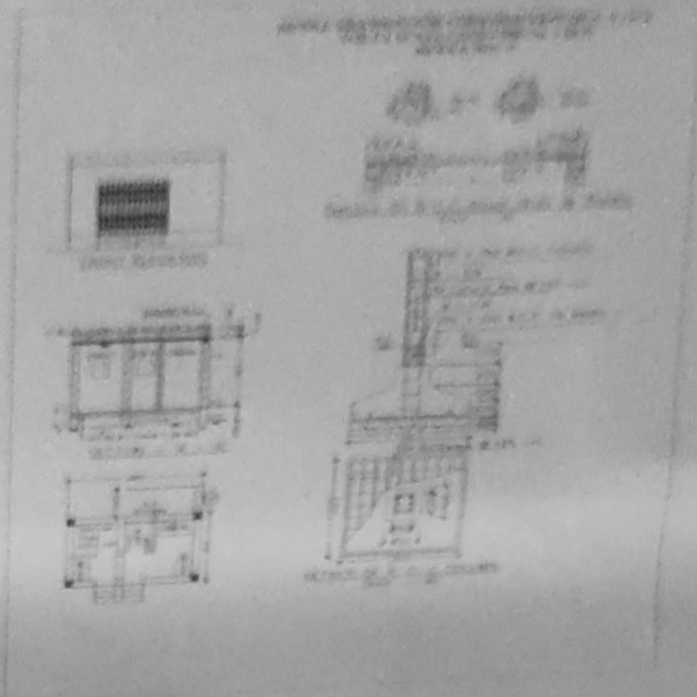

Jnanada Devi High School

(Signature)
 Sub Assistant Engineer
 Dinhata Municipality