



SURI MUNICIPALITY
JOINT SITE INSPECTION REPORT

Annexure-III

Location Details

Name of the Location	Latitude & Longitude	Ward	Area	Area Unit
BHARAT SEVASHRAM SANGHA, LALKUTHI PARA, SURI	23.9152252 87.523582	5	50	Sq. Ft.

Project Details

Proposed Project Type	Toilet Seat (Male)	Toilet Seat (Female)	Urinal Seat (Male)	Urinal Seat (Female)
Institutional Toilet Block	5	5	5	5

Land Details

Classification	Plot No.	Jl No.	Dag No.	Khatian No.	Mouza	Possession Details (Owned by)
Path	277	7	277	1120	CHANDNI SAHEBGANG	

Signature

Visit Date	2023 06 28
Nearest location of CT/PT (approx)	BHARAT SEVASHRAM SANGHA, LAIPUTEH PARA, SURI
Toilet Type (Aspirational/Normal)	Normal Toilet
Model Name	CT/PT - Model No A
Male Toilet Seats	2
Female Toilet Seats	3
Male Urinal	③ 2
Female Urinal	3
Male Bath	0
Female Bath	0
Children Feed	0
Children Feed	0
No Of Toilet Seats	5
No Of Urinal Seats	5
total Baths	0
Bath	0
Area	7.5m x 7.7m
Cubical Male	1200 x 1000 mm
Cubical Female	1800 x 1000 mm
Cubical Urinal Seat Size	600/500
Space for Soakpit/Soak Well	Available
Water Availability (Details)	Piped water supply (in detail) - (Municipal Pipe water
Operation and Maintenance Plan	Other (specify)
Remarks	Maintenance by BHARAT SEVASHRAM SANGHA committee

Name: Rahul Saha

Designation: SAE

Contact No: 8972220900

Date: _____

Name: Abhik Mallick

Rahul Saha
 Signature with stamp Sub-Assistant Engineer
 (CIVIL)
 Suri Municipality

 Saha
 Municipal
 Panima

Checked & Verified
 Engineer (Civil)
 ATION

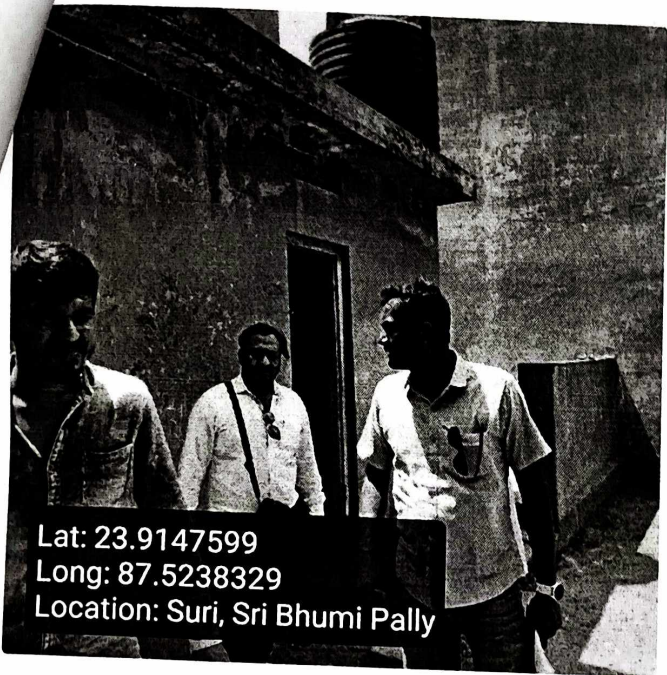

Lat: 23.9147599
Long: 87.5238329
Location: Suri, Sri Bhumi Pally

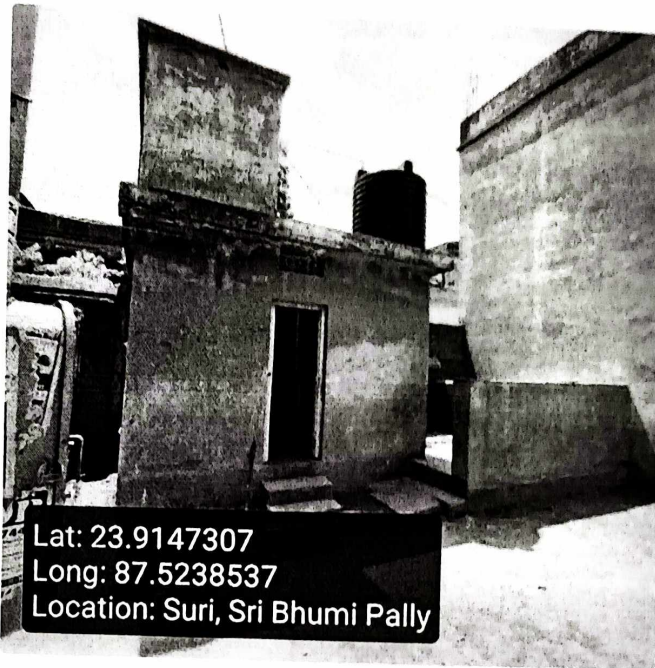

Lat: 23.9147307
Long: 87.5238537
Location: Suri, Sri Bhumi Pally

Executive Officer
Suri Municipality

Chairman
Suri Municipality
SURI:: BIRBHUM

भारतीय गैर न्यायिक

बीस रुपये

रु.20

भारत



Rs.20

TWENTY
RUPEES

INDIA NON JUDICIAL

पश्चिमबङ्ग पश्चिम बंगाल WEST BENGAL

30AA 254302

I Swami Subhananda Secretary of Bharat Sevashram Sangha PO & PS Suri, Dist Birbhum, do hereby solemnly affirm and declare as follows,

That Suri Municipality will Construct a toilet in our Ashram premises, I have no objection in this matter. I am giving permission to Chairman, Suri Municipality for construction of toilet in our Ashram at Suri.

Mouza - Chandnisahebganj . JL no-7 . Dag no- 277
Khatian no- 1120



Swami Subhananda
Secretary
Bharat Sevashram Sangha
Suri Branch

06-07-2025